

ANAEROBIC DIGESTER FACILITY  
CITY OF DESERT HOT SPRINGS, CA

SCOPE OF WORK

NEW ANEROBIC DIGESTER FACILITY TO PROCESS ORGANIC WASTE  
AND TURN INTO BIOMETHANE GAS

PARKING CALCULATIONS

NAME & USE OF SPACE	OCC. GROUP	AREA (S.F.)	OCC. FACTOR	REQUIRED
OFFICE BUILDING	B	3000	500	6
ANAEROBIC DIGESTER BUILDING	F	22900	1,000	23
TOTAL REQUIRED				29
TOTAL PROVIDED				30

DEFERRED SUBMITTALS

FIRE SPRINKLER SYSTEM AND FIRE ALARM ARE A DEFERRED  
SUBMITTAL UNDER SEPARATE PERMIT.

SCOPE OF WORK

- CONSTRUCTION OF AN ANAEROBIC DIGESTER (AD) BUILDING.
- CONSTRUCTION OF AN OFFICE BUILDING.

APPLICABLE CODES

ALL WORK SHALL COMPLY WITH THE FOLLOWING CODES  
INCLUDING LOCAL AMENDMENTS.

2016 CALIFORNIA BUILDING CODE  
2016 CALIFORNIA RESIDENTIAL CODE  
2016 CALIFORNIA FIRE CODE  
2016 CALIFORNIA PLUMBING CODE  
2016 CALIFORNIA MECHANICAL CODE  
2016 CALIFORNIA ELECTRICAL CODE  
2016 CALIFORNIA GREEN BUILDING CODE  
2016 CALIFORNIA BUILDING ENERGY EFFICIENCY STANDARDS

SHEET INDEX

A1.0	TITLE PAGE / SITE PLAN
A2.0	OFFICE BUILDING FLOOR PLAN
A3.0	ANAEROBIC DIGESTER (AD) FACILITY FLOOR PLAN
A4.0	OFFICE BUILDING ELEVATIONS
A5.0	AD FACILITY BUILDING ELEVATIONS
A5.1	AD FACILITY BUILDING ELEVATIONS

PROJECT INFORMATION

APN : 666-360-015  
LOT COVERAGE : 420,750 SF  
**BUILDING - 1 :** (ANAEROBIC DIGESTER) 22,900 S.F.  
OCCUPANCY GROUP : FACTORY INDUSTRIAL, F-1  
TYPE OF CONSTRUCTION : IIIB  
FIRE SPRINKLERS : YES  
**BUILDING - 2 :** (OFFICE) 3,000 S.F.  
OCCUPANCY GROUP : OFFICE, B  
TYPE OF CONSTRUCTION : IIIB  
FIRE SPRINKLERS : YES  
**TOTAL BUILDING FOOTPRINT = 25,900 SF**  
**LOT COVERAGE = 16%**

OCCUPANCY CALCULATIONS	2016 CBC TABLE 1004.1.2
	SQ.FT. OCC. FACTOR OCC. LOAD
ANAEROBIC DIGESTER (INDUSTRIAL)	2,300 100 27
OFFICE (GROUP B) :	3,000 100 30

KEYNOTES

- 550,000 GAL. HIGH SOLIDS TTV DIGESTER
- FEEDSTOCK RECEIVING
- FEEDSTOCK PROCESSING
- TRUCK SCALE
- HEATING, ELECTRICAL & CONTROLS
- NUTRIENT LIQUID STORAGE
- BIO FILTER
- DEWATERING
- DIGESTATE STAGING & BLENDING
- OFFICE (3,000 S.F.)
- BIOGAS UPGRADER
- THERMAL OXIDIZER
- GATED SITE ENTRANCE / EXIT
- TRUCK TURNAROUND
- SAFETY FLARE & CONDENSATE WELL
- STAFF & VISITOR PARKING AREA
- 6" PRECISION FACE BLOCK WALL
- PERIMETER EARTH BERM
- TRASH ENCLOSURE

KEY MAP

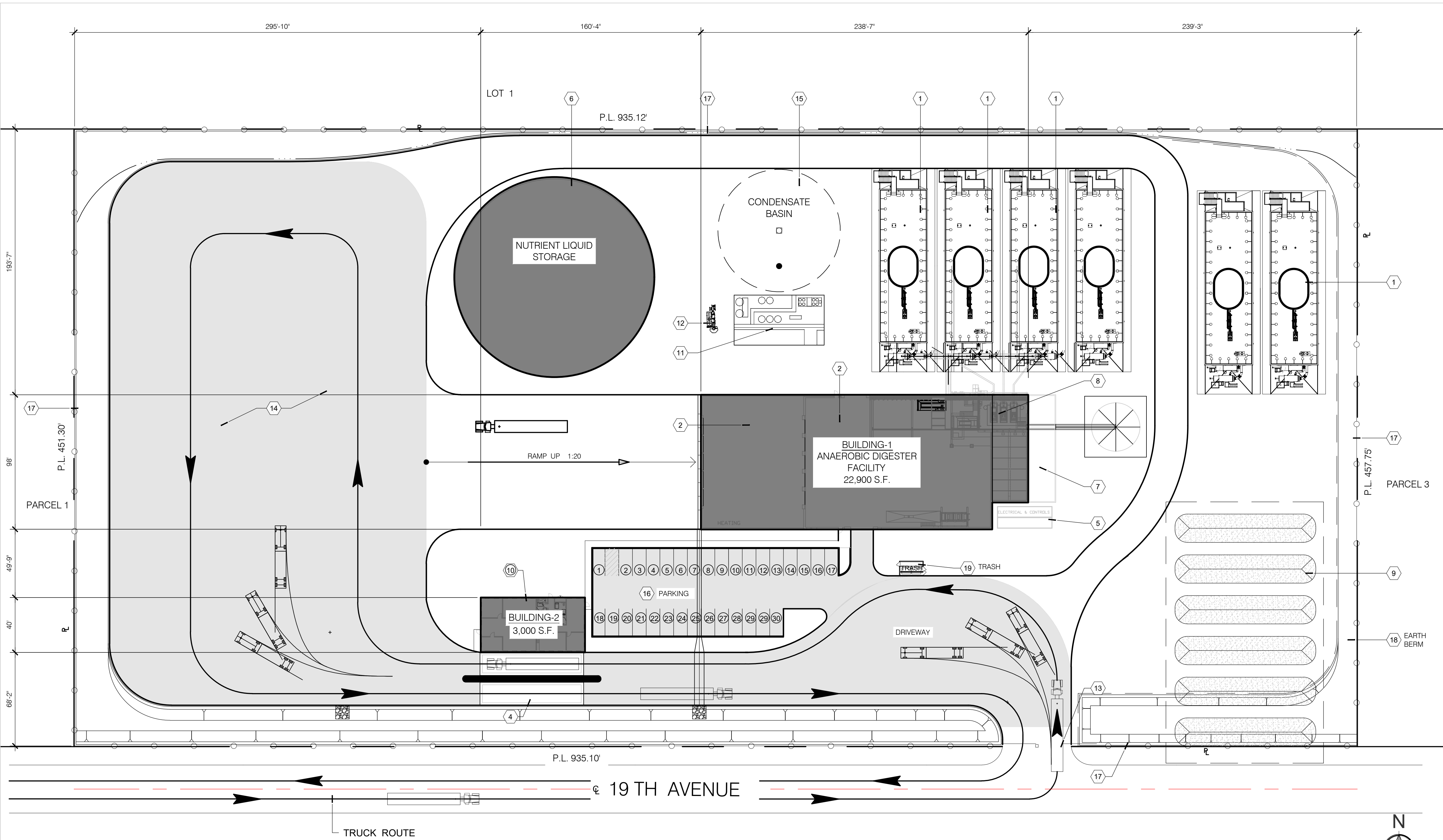
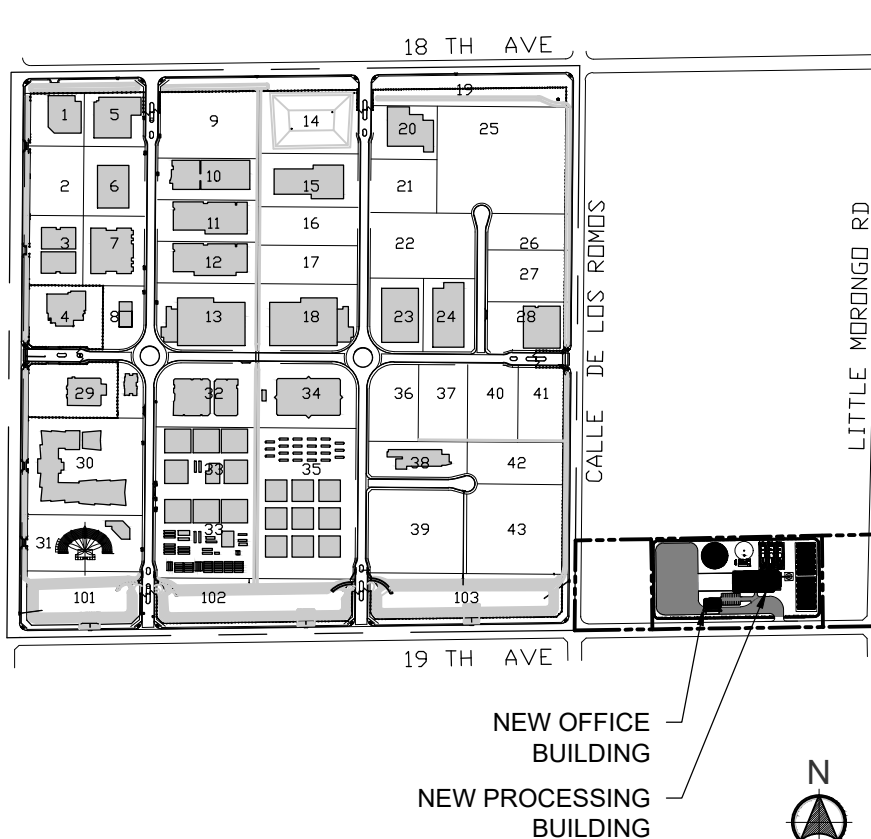

SITE PLAN

SCALE : 1" = 40'

No. Revision/Issue

SHEET TITLE  
TITLE PAGE / SITE PLAN

CLIENT  
AD FACILITY  
INDIAN AVENUE  
DESERT HOT SPRINGS, CA

SCALE: AS NOTED

DATE: 01-02-20

DRAWN BY: TEAM

PROJECT NO:  
1942

SHEET NO:

A1.0 OF X

valley design  
230 W AVENIDA VALENCIA, SAN CLEMENTE CA 92672  
(909) 576-5859