

TENTATIVE TRACT MAP

No. 37300

A PORTION OF SECTION 29, T2S, R5E, S8M, IN THE CITY OF CITY OF DESERT HOT SPRINGS, COUNTY OF RIVERSIDE, STATE OF CALIFORNIA, ACCORDING TO THE OFFICIAL PLAT OF SAID LAND APPROVED BY THE SURVEYOR GENERAL

LUDWIG ENGINEERING

MARCH 2017

OWNER

Walton Development and Management, Southwest USA
4800 N. Scottsdale Road, Suite 4000
Scottsdale, AZ 85251

DEVELOPER

Walton Development and Management, Southwest USA
4800 N. Scottsdale Road, Suite 4000
Scottsdale, AZ 85251

ENGINEER

Ludwig Engineering Associate, Inc.
109 East Third Street
San Bernardino, CA 92410
Phone (909)884-5217
Fax (909)888-0153

SOILS ENGINEER

LJR Geotechnical
6121 Quail Valley Court
Riverside, CA 92507
(951) 653-1760

ASSESSORS PARCEL

638-270-002, 003, 004, 005, and 006; 638-330-001, 002, and 003; 638-340-005, 006, and 007

ZONE

EXISTING: ESTABLISHED SPECIFIC PLAN, RURAL DESERT RESIDENTIAL
PROPOSED: SPECIFIC PLAN

GENERAL PLAN

EXISTING: COMMERCIAL GENERAL (C-G), RESIDENTIAL HIGH DENSITY (R-H), RESIDENTIAL VISITOR SERVING (HIGH DENSITY) RV-S-H, PRIVATE OPEN SPACE (OSP)
PROPOSED: MEDIUM DENSITY-RESIDENTIAL (R-MSP), PRIVATE OPEN SPACE (OSP/PS/P)

LOTS

NUMBERED LOTS SUBDIVIDED	HOA LOTS	LETTERED LOTS	TOTAL NUMBER OF LOTS	ACREAGE	UNITS PER ACRE
PA-1	170	4	175	36.85	4.75

MINIMUM LOT SIZE RES.: 4664 SQ. FT.

LEGAL DESCRIPTION

A PORTION OF REAL PROPERTY IN THE CITY OF DESERT HOT SPRINGS, COUNTY OF RIVERSIDE, STATE OF CALIFORNIA, DESCRIBED AS FOLLOWS:
PARCEL A-1 (APN: 638-270-002-3, 638-330-002-3, 638-340-003-4, 638-340-005-3, 638-340-006-3)

SECTION 29, TOWNSHIP 2 SOUTH, RANGE 5 EAST, IN THE CITY OF DESERT HOT SPRINGS, COUNTY OF RIVERSIDE, STATE OF CALIFORNIA, AS SHOWN BY UNITED STATES GOVERNMENT SURVEY, EXCEPTING THEREFROM THE WEST 1425 FEET

ALSO EXCEPTING THAT PORTION OF SECTION 29, TOWNSHIP 2 SOUTH, RANGE 5 EAST, SAN BERNARDINO BASE AND MERIDIAN, AS SHOWN BY UNITED STATES GOVERNMENT SURVEY DESCRIBED AS:

A PARCEL BEGINNING AT A POINT ON THE SOUTHERLY LINE OF SECTION 29 DISTANT 1425.00 FEET FROM THE SOUTHWESTERLY CORNER OF SECTION 29; THENCE SOUTHERLY 89° 52' EAST; ALONG SAID SECTION LINE 2000.00 FEET; THENCE NORTH 60° 08' EAST 800.00 FEET; THENCE SOUTH 89° 52' EAST 204.19 FEET; THENCE NORTH 0° 08' EAST 800.00 FEET; THENCE NORTH 89° 52' WEST 1127.51 FEET; THENCE SOUTH 45° 08' WEST 1131.37 FEET; THENCE NORTH 89° 52' WEST 889.50 FEET TO A POINT ON THE EASTERLY LINE OF THE WEST 1425 FEET OF SAID SECTION 29; THENCE SOUTHERLY ALONG SAID EASTERLY LINE TO THE POINT OF BEGINNING.

PARCEL A-2
TOGETHER WITH AN EASEMENT FOR STREET PURPOSES OVER THAT PORTION OF SECTION 29, TOWNSHIP 2 SOUTH, RANGE 5 EAST, SAN BERNARDINO BASE AND MERIDIAN, AS SHOWN BY UNITED STATES GOVERNMENT SURVEY DESCRIBED AS FOLLOWS:

COMMENCING AT A POINT ON THE SOUTHERLY LINE OF SECTION 29 DISTANT 1425.00 FEET FROM THE SOUTHWESTERLY CORNER OF SAID SECTION 29; THENCE SOUTHERLY 89° 52' EAST; ALONG SAID SECTION LINE 2000.00 FEET; THENCE NORTH 60° 08' EAST 800.00 FEET; THENCE SOUTH 89° 52' EAST 204.19 FEET; THENCE NORTH 0° 08' EAST 800.00 FEET; THENCE NORTH 89° 52' WEST 1127.51 FEET; THENCE SOUTH 45° 08' WEST 1131.37 FEET TO THE TRUE POINT OF BEGINNING; THENCE NORTH 89° 52' WEST 80 FEET; THENCE SOUTHERLY PARALLEL WITH THE WESTERLY LINE OF SECTION 29 A DISTANCE OF 400 FEET MORE OR LESS TO A POINT ON THE SOUTHERLY LINE OF SECTION 29; THENCE EASTERLY ALONG THE SOUTHERLY LINE OF SECTION 29 A DISTANCE OF 40 FEET; THENCE NORTHERLY 400 FEET MORE OR LESS TO THE TRUE POINT OF BEGINNING.

PARCEL NO. B (APN: 638-340-003-9)
THE SOUTHERLY 3,668.20 FEET OF THE EASTERLY 475.00 FEET OF THE WESTERLY 1,425.00 FEET OF THE WEST HALF OF SECTION 29, TOWNSHIP 2 SOUTH, RANGE 5 EAST, SAN BERNARDINO BASE AND MERIDIAN, IN THE CITY OF DESERT HOT SPRINGS, COUNTY OF RIVERSIDE, STATE OF CALIFORNIA, AS SHOWN BY UNITED STATES GOVERNMENT SURVEY DESCRIBED AS FOLLOWS:

BEGINNING AT A POINT ON THE SOUTHERLY LINE OF SECTION 29 DISTANT 1425.00 FEET FROM THE SOUTHWESTERLY CORNER OF SAID SECTION 29; THENCE SOUTHERLY 89° 52' EAST; ALONG SAID SECTION LINE 2000.00 FEET; THENCE NORTH 60° 08' EAST 800.00 FEET; THENCE SOUTH 89° 52' EAST 204.19 FEET; THENCE NORTH 0° 08' EAST 800.00 FEET; THENCE NORTH 89° 52' WEST 1127.51 FEET; THENCE SOUTH 45° 08' WEST 1131.37 FEET TO THE TRUE POINT OF BEGINNING; THENCE NORTH 89° 52' WEST 80 FEET; THENCE SOUTHERLY PARALLEL WITH THE WESTERLY LINE OF SECTION 29 A DISTANCE OF 400 FEET MORE OR LESS TO A POINT ON THE SOUTHERLY LINE OF SECTION 29; THENCE EASTERLY ALONG THE SOUTHERLY LINE OF SECTION 29 A DISTANCE OF 40 FEET; THENCE NORTHERLY 400 FEET MORE OR LESS TO THE TRUE POINT OF BEGINNING.

PARCEL NO. C (APN: 638-340-007-9)
THAT PORTION OF SECTION 29, TOWNSHIP 2 SOUTH, RANGE 5 EAST, SAN BERNARDINO BASE AND MERIDIAN, IN THE CITY OF DESERT HOT SPRINGS, COUNTY OF RIVERSIDE, STATE OF CALIFORNIA, AS SHOWN BY UNITED STATES GOVERNMENT SURVEY DESCRIBED AS FOLLOWS:

BEGINNING AT A POINT ON THE SOUTHERLY LINE OF SECTION 29 DISTANT 1425.00 FEET FROM THE SOUTHWESTERLY CORNER OF SAID SECTION 29; THENCE SOUTHERLY 89° 52' EAST; ALONG SAID SECTION LINE 2000.00 FEET; THENCE NORTH 60° 08' EAST 800.00 FEET; THENCE SOUTH 89° 52' EAST 204.19 FEET; THENCE NORTH 0° 08' EAST 800.00 FEET; THENCE NORTH 89° 52' WEST 1127.51 FEET; THENCE SOUTH 45° 08' WEST 1131.37 FEET TO THE TRUE POINT OF BEGINNING; THENCE NORTH 89° 52' WEST 80 FEET; THENCE SOUTHERLY PARALLEL WITH THE WESTERLY LINE OF SECTION 29 A DISTANCE OF 400 FEET MORE OR LESS TO A POINT ON THE SOUTHERLY LINE OF SECTION 29; THENCE EASTERLY ALONG THE SOUTHERLY LINE OF SECTION 29 A DISTANCE OF 40 FEET; THENCE NORTHERLY 400 FEET MORE OR LESS TO THE TRUE POINT OF BEGINNING.

PARCEL D (APN: 638-270-002-6, 638-270-003-9, 638-270-004-4, 638-270-005-1)
THAT PORTION OF THE NORTHWEST QUARTER OF SECTION 29, TOWNSHIP 2 SOUTH, RANGE 5 EAST, SAN BERNARDINO BASE AND MERIDIAN, ACCORDING TO THE OFFICIAL PLAT THEREOF, DESCRIBED AS FOLLOWS:

BEGINNING AT A POINT ON THE WEST LINE OF SAID SECTION, DISTANT THEREON SOUTH 0° 05' 00" EAST, 540.73 FEET FROM THE NORTHWEST CORNER FOR THE TRUE POINT OF BEGINNING, BEING THE BEGINNING OF THE CENTER LINE OF THAT CERTAIN EASEMENT 30 FEET WIDE, DESCRIBED AS PARCEL 2, IN AND TO DESERT HOT SPRINGS COUNTY WATER DISTRICT RECORDED MARCH 14, 1956 AS INSTRUMENT NO. 18580 IN BOOK 1879, PAGE 238 OF OFFICIAL RECORDS; THENCE NORTH 89° 54' 10" EAST 174.58 FEET ON SAID CENTER LINE; THENCE NORTH 89° 20' 17" EAST, 268.61 FEET ON SAID CENTER LINE; THENCE NORTH 89° 45' 00" EAST, 304.74 FEET ON SAID CENTER LINE; THENCE NORTH 48° 16' 00" EAST, 67.10 FEET ON SAID CENTER LINE TO A POINT ON THE SOUTHWEST LINE OF PARCEL 1, DESCRIBED IN SAID DEED; THENCE SOUTH 41° 43' 00" EAST, 87.50 FEET ON THE SOUTHWEST LINE OF SAID PARCEL, TO THE MOST WESTERLY CORNER THEREOF; THENCE NORTH 48° 16' 00" EAST, 125.00 FEET ON THE SOUTHEAST LINE OF SAID PARCEL, TO THE MOST EASTERLY CORNER THEREOF; THENCE 41° 43' 00" WEST, 86.87 FEET ON THE NORTHEAST LINE OF SAID PARCEL TO A POINT ON THE NORTH LINE OF SAID SECTION; THENCE SOUTH 89° 54' 40" EAST, 763.00 FEET ON SAID NORTH LINE TO THE NORTHEAST CORNER OF THE WEST 1425.00 FEET OF SAID SECTION; THENCE SOUTH 0° 02' 00" EAST, 1648.38 FEET ON THE LINE OF THE WEST 1425.00 FEET OF SAID SECTION; THENCE NORTH 89° 52' WEST, 615.00 FEET; MORE OR LESS, AND ON THE NORTH LINE OF LOT 7 OF TRACT 27300, AS SHOWN BY MAP ON FILE IN BOOK 40, PAGE 94 OF MAPS, RIVERSIDE COUNTY RECORDS, EXTENDED EASTERLY TO THE NORTHWEST CORNER OF SAID LOT 6; THENCE NORTH 0° 00' 00" EAST, 55.00 FEET ON THE EAST LINE OF LOT 3 OF SAID TRACT TO THE NORTHEAST CORNER THEREOF; THENCE NORTH 87° 14' 10" WEST ON THE NORTHEAST LINE OF SAID LOT 3; AND THE SOUTHWEST LINE OF SAID FLOOD CONTROL EASEMENT TO THE BEGINNING OF A CURVE, CONCAVE SOUTHWESTERLY WITH A RADIUS OF 1450.00 FEET; THENCE NORTHWESTERLY 167.45 FEET FROM THE ARC OF SAID CURVE TO THE WEST LINE OF SAID SECTION; THENCE NORTH 00° 50' WEST, 691.15 FEET ON SAID WEST LINE TO THE POINT OF BEGINNING.

PARCEL E (APN: 638-330-001-2)
THE SOUTHERLY 3,668.20 FEET OF THE EASTERLY 475.00 FEET OF THE WESTERLY 1,425.00 FEET OF THE WEST HALF OF SECTION 29, TOWNSHIP 2 SOUTH, RANGE 5 EAST, SAN BERNARDINO BASE AND MERIDIAN, IN THE CITY OF DESERT HOT SPRINGS, COUNTY OF RIVERSIDE, STATE OF CALIFORNIA, AS SHOWN BY UNITED STATES GOVERNMENT SURVEY, EXCEPT THAT PORTION LYING SOUTH OF THE CENTER LINE OF SECTION 29, TOWNSHIP 2 SOUTH, RANGE 5 EAST, SAN BERNARDINO BASE AND MERIDIAN.

THE SOUTHERLY 3,668.20 FEET OF THE EASTERLY 475.00 FEET OF THE WESTERLY 1,425.00 FEET OF THE WEST HALF OF SECTION 29, TOWNSHIP 2 SOUTH, RANGE 5 EAST, SAN BERNARDINO BASE AND MERIDIAN, IN THE CITY OF DESERT HOT SPRINGS, COUNTY OF RIVERSIDE, STATE OF CALIFORNIA, AS SHOWN BY UNITED STATES GOVERNMENT SURVEY, EXCEPT THAT PORTION LYING SOUTH OF THE CENTER LINE OF SECTION 29, TOWNSHIP 2 SOUTH, RANGE 5 EAST, SAN BERNARDINO BASE AND MERIDIAN.

THE SOUTHERLY 3,668.20 FEET OF THE EASTERLY 475.00 FEET OF THE WESTERLY 1,425.00 FEET OF THE WEST HALF OF SECTION 29, TOWNSHIP 2 SOUTH, RANGE 5 EAST, SAN BERNARDINO BASE AND MERIDIAN, IN THE CITY OF DESERT HOT SPRINGS, COUNTY OF RIVERSIDE, STATE OF CALIFORNIA, AS SHOWN BY UNITED STATES GOVERNMENT SURVEY, EXCEPT THAT PORTION LYING SOUTH OF THE CENTER LINE OF SECTION 29, TOWNSHIP 2 SOUTH, RANGE 5 EAST, SAN BERNARDINO BASE AND MERIDIAN.

THE SOUTHERLY 3,668.20 FEET OF THE EASTERLY 475.00 FEET OF THE WESTERLY 1,425.00 FEET OF THE WEST HALF OF SECTION 29, TOWNSHIP 2 SOUTH, RANGE 5 EAST, SAN BERNARDINO BASE AND MERIDIAN, IN THE CITY OF DESERT HOT SPRINGS, COUNTY OF RIVERSIDE, STATE OF CALIFORNIA, AS SHOWN BY UNITED STATES GOVERNMENT SURVEY, EXCEPT THAT PORTION LYING SOUTH OF THE CENTER LINE OF SECTION 29, TOWNSHIP 2 SOUTH, RANGE 5 EAST, SAN BERNARDINO BASE AND MERIDIAN.

THE SOUTHERLY 3,668.20 FEET OF THE EASTERLY 475.00 FEET OF THE WESTERLY 1,425.00 FEET OF THE WEST HALF OF SECTION 29, TOWNSHIP 2 SOUTH, RANGE 5 EAST, SAN BERNARDINO BASE AND MERIDIAN, IN THE CITY OF DESERT HOT SPRINGS, COUNTY OF RIVERSIDE, STATE OF CALIFORNIA, AS SHOWN BY UNITED STATES GOVERNMENT SURVEY, EXCEPT THAT PORTION LYING SOUTH OF THE CENTER LINE OF SECTION 29, TOWNSHIP 2 SOUTH, RANGE 5 EAST, SAN BERNARDINO BASE AND MERIDIAN.

THE SOUTHERLY 3,668.20 FEET OF THE EASTERLY 475.00 FEET OF THE WESTERLY 1,425.00 FEET OF THE WEST HALF OF SECTION 29, TOWNSHIP 2 SOUTH, RANGE 5 EAST, SAN BERNARDINO BASE AND MERIDIAN, IN THE CITY OF DESERT HOT SPRINGS, COUNTY OF RIVERSIDE, STATE OF CALIFORNIA, AS SHOWN BY UNITED STATES GOVERNMENT SURVEY, EXCEPT THAT PORTION LYING SOUTH OF THE CENTER LINE OF SECTION 29, TOWNSHIP 2 SOUTH, RANGE 5 EAST, SAN BERNARDINO BASE AND MERIDIAN.

THE SOUTHERLY 3,668.20 FEET OF THE EASTERLY 475.00 FEET OF THE WESTERLY 1,425.00 FEET OF THE WEST HALF OF SECTION 29, TOWNSHIP 2 SOUTH, RANGE 5 EAST, SAN BERNARDINO BASE AND MERIDIAN, IN THE CITY OF DESERT HOT SPRINGS, COUNTY OF RIVERSIDE, STATE OF CALIFORNIA, AS SHOWN BY UNITED STATES GOVERNMENT SURVEY, EXCEPT THAT PORTION LYING SOUTH OF THE CENTER LINE OF SECTION 29, TOWNSHIP 2 SOUTH, RANGE 5 EAST, SAN BERNARDINO BASE AND MERIDIAN.

THE SOUTHERLY 3,668.20 FEET OF THE EASTERLY 475.00 FEET OF THE WESTERLY 1,425.00 FEET OF THE WEST HALF OF SECTION 29, TOWNSHIP 2 SOUTH, RANGE 5 EAST, SAN BERNARDINO BASE AND MERIDIAN, IN THE CITY OF DESERT HOT SPRINGS, COUNTY OF RIVERSIDE, STATE OF CALIFORNIA, AS SHOWN BY UNITED STATES GOVERNMENT SURVEY, EXCEPT THAT PORTION LYING SOUTH OF THE CENTER LINE OF SECTION 29, TOWNSHIP 2 SOUTH, RANGE 5 EAST, SAN BERNARDINO BASE AND MERIDIAN.

THE SOUTHERLY 3,668.20 FEET OF THE EASTERLY 475.00 FEET OF THE WESTERLY 1,425.00 FEET OF THE WEST HALF OF SECTION 29, TOWNSHIP 2 SOUTH, RANGE 5 EAST, SAN BERNARDINO BASE AND MERIDIAN, IN THE CITY OF DESERT HOT SPRINGS, COUNTY OF RIVERSIDE, STATE OF CALIFORNIA, AS SHOWN BY UNITED STATES GOVERNMENT SURVEY, EXCEPT THAT PORTION LYING SOUTH OF THE CENTER LINE OF SECTION 29, TOWNSHIP 2 SOUTH, RANGE 5 EAST, SAN BERNARDINO BASE AND MERIDIAN.

THE SOUTHERLY 3,668.20 FEET OF THE EASTERLY 475.00 FEET OF THE WESTERLY 1,425.00 FEET OF THE WEST HALF OF SECTION 29, TOWNSHIP 2 SOUTH, RANGE 5 EAST, SAN BERNARDINO BASE AND MERIDIAN, IN THE CITY OF DESERT HOT SPRINGS, COUNTY OF RIVERSIDE, STATE OF CALIFORNIA, AS SHOWN BY UNITED STATES GOVERNMENT SURVEY, EXCEPT THAT PORTION LYING SOUTH OF THE CENTER LINE OF SECTION 29, TOWNSHIP 2 SOUTH, RANGE 5 EAST, SAN BERNARDINO BASE AND MERIDIAN.

THE SOUTHERLY 3,668.20 FEET OF THE EASTERLY 475.00 FEET OF THE WESTERLY 1,425.00 FEET OF THE WEST HALF OF SECTION 29, TOWNSHIP 2 SOUTH, RANGE 5 EAST, SAN BERNARDINO BASE AND MERIDIAN, IN THE CITY OF DESERT HOT SPRINGS, COUNTY OF RIVERSIDE, STATE OF CALIFORNIA, AS SHOWN BY UNITED STATES GOVERNMENT SURVEY, EXCEPT THAT PORTION LYING SOUTH OF THE CENTER LINE OF SECTION 29, TOWNSHIP 2 SOUTH, RANGE 5 EAST, SAN BERNARDINO BASE AND MERIDIAN.

THE SOUTHERLY 3,668.20 FEET OF THE EASTERLY 475.00 FEET OF THE WESTERLY 1,425.00 FEET OF THE WEST HALF OF SECTION 29, TOWNSHIP 2 SOUTH, RANGE 5 EAST, SAN BERNARDINO BASE AND MERIDIAN, IN THE CITY OF DESERT HOT SPRINGS, COUNTY OF RIVERSIDE, STATE OF CALIFORNIA, AS SHOWN BY UNITED STATES GOVERNMENT SURVEY, EXCEPT THAT PORTION LYING SOUTH OF THE CENTER LINE OF SECTION 29, TOWNSHIP 2 SOUTH, RANGE 5 EAST, SAN BERNARDINO BASE AND MERIDIAN.

THE SOUTHERLY 3,668.20 FEET OF THE EASTERLY 475.00 FEET OF THE WESTERLY 1,425.00 FEET OF THE WEST HALF OF SECTION 29, TOWNSHIP 2 SOUTH, RANGE 5 EAST, SAN BERNARDINO BASE AND MERIDIAN, IN THE CITY OF DESERT HOT SPRINGS, COUNTY OF RIVERSIDE, STATE OF CALIFORNIA, AS SHOWN BY UNITED STATES GOVERNMENT SURVEY, EXCEPT THAT PORTION LYING SOUTH OF THE CENTER LINE OF SECTION 29, TOWNSHIP 2 SOUTH, RANGE 5 EAST, SAN BERNARDINO BASE AND MERIDIAN.

THE SOUTHERLY 3,668.20 FEET OF THE EASTERLY 475.00 FEET OF THE WESTERLY 1,425.00 FEET OF THE WEST HALF OF SECTION 29, TOWNSHIP 2 SOUTH, RANGE 5 EAST, SAN BERNARDINO BASE AND MERIDIAN, IN THE CITY OF DESERT HOT SPRINGS, COUNTY OF RIVERSIDE, STATE OF CALIFORNIA, AS SHOWN BY UNITED STATES GOVERNMENT SURVEY, EXCEPT THAT PORTION LYING SOUTH OF THE CENTER LINE OF SECTION 29, TOWNSHIP 2 SOUTH, RANGE 5 EAST, SAN BERNARDINO BASE AND MERIDIAN.

THE SOUTHERLY 3,668.20 FEET OF THE EASTERLY 475.00 FEET OF THE WESTERLY 1,425.00 FEET OF THE WEST HALF OF SECTION 29, TOWNSHIP 2 SOUTH, RANGE 5 EAST, SAN BERNARDINO BASE AND MERIDIAN, IN THE CITY OF DESERT HOT SPRINGS, COUNTY OF RIVERSIDE, STATE OF CALIFORNIA, AS SHOWN BY UNITED STATES GOVERNMENT SURVEY, EXCEPT THAT PORTION LYING SOUTH OF THE CENTER LINE OF SECTION 29, TOWNSHIP 2 SOUTH, RANGE 5 EAST, SAN BERNARDINO BASE AND MERIDIAN.

THE SOUTHERLY 3,668.20 FEET OF THE EASTERLY 475.00 FEET OF THE WESTERLY 1,425.00 FEET OF THE WEST HALF OF SECTION 29, TOWNSHIP 2 SOUTH, RANGE 5 EAST, SAN BERNARDINO BASE AND MERIDIAN, IN THE CITY OF DESERT HOT SPRINGS, COUNTY OF RIVERSIDE, STATE OF CALIFORNIA, AS SHOWN BY UNITED STATES GOVERNMENT SURVEY, EXCEPT THAT PORTION LYING SOUTH OF THE CENTER LINE OF SECTION 29, TOWNSHIP 2 SOUTH, RANGE 5 EAST, SAN BERNARDINO BASE AND MERIDIAN.

THE SOUTHERLY 3,668.20 FEET OF THE EASTERLY 475.00 FEET OF THE WESTERLY 1,425.00 FEET OF THE WEST HALF OF SECTION 29, TOWNSHIP 2 SOUTH, RANGE 5 EAST, SAN BERNARDINO BASE AND MERIDIAN, IN THE CITY OF DESERT HOT SPRINGS, COUNTY OF RIVERSIDE, STATE OF CALIFORNIA, AS SHOWN BY UNITED STATES GOVERNMENT SURVEY, EXCEPT THAT PORTION LYING SOUTH OF THE CENTER LINE OF SECTION 29, TOWNSHIP 2 SOUTH, RANGE 5 EAST, SAN BERNARDINO BASE AND MERIDIAN.

THE SOUTHERLY 3,668.20 FEET OF THE EASTERLY 475.00 FEET OF THE WESTERLY 1,425.00 FEET OF THE WEST HALF OF SECTION 29, TOWNSHIP 2 SOUTH, RANGE 5 EAST, SAN BERNARDINO BASE AND MERIDIAN, IN THE CITY OF DESERT HOT SPRINGS, COUNTY OF RIVERSIDE, STATE OF CALIFORNIA, AS SHOWN BY UNITED STATES GOVERNMENT SURVEY, EXCEPT THAT PORTION LYING SOUTH OF THE CENTER LINE OF SECTION 29, TOWNSHIP 2 SOUTH, RANGE 5 EAST, SAN BERNARDINO BASE AND MERIDIAN.

THE SOUTHERLY 3,668.20 FEET OF THE EASTERLY 475.00 FEET OF THE WESTERLY 1,425.00 FEET OF THE WEST HALF OF SECTION 29, TOWNSHIP 2 SOUTH, RANGE 5 EAST, SAN BERNARDINO BASE AND MERIDIAN, IN THE CITY OF DESERT HOT SPRINGS, COUNTY OF RIVERSIDE, STATE OF CALIFORNIA, AS SHOWN BY UNITED STATES GOVERNMENT SURVEY, EXCEPT THAT PORTION LYING SOUTH OF THE CENTER LINE OF SECTION 29, TOWNSHIP 2 SOUTH, RANGE 5 EAST, SAN BERNARDINO BASE AND MERIDIAN.

THE SOUTHERLY 3,668.20 FEET OF THE EASTERLY 475.00 FEET OF THE WESTERLY 1,425.00 FEET OF THE WEST HALF OF SECTION 29, TOWNSHIP 2 SOUTH, RANGE 5 EAST, SAN BERNARDINO BASE AND MERIDIAN, IN THE CITY OF DESERT HOT SPRINGS, COUNTY OF RIVERSIDE, STATE OF CALIFORNIA, AS SHOWN BY UNITED STATES GOVERNMENT SURVEY, EXCEPT THAT PORTION LYING SOUTH OF THE CENTER LINE OF SECTION 29, TOWNSHIP 2 SOUTH, RANGE 5 EAST, SAN BERNARDINO BASE AND MERIDIAN.

THE SOUTHERLY 3,668.20 FEET OF THE EASTERLY 475.00 FEET OF THE WESTERLY 1,425.00 FEET OF THE WEST HALF OF SECTION 29, TOWNSHIP 2 SOUTH, RANGE 5 EAST, SAN BERNARDINO BASE AND MERIDIAN, IN THE CITY OF DESERT HOT SPRINGS, COUNTY OF RIVERSIDE, STATE OF CALIFORNIA, AS SHOWN BY UNITED STATES GOVERNMENT SURVEY, EXCEPT THAT PORTION LYING SOUTH OF THE CENTER LINE OF SECTION 29, TOWNSHIP 2 SOUTH, RANGE 5 EAST, SAN BERNARDINO BASE AND MERIDIAN.

THE SOUTHERLY 3,668.20 FEET OF THE EASTERLY 475.00 FEET OF THE WESTERLY 1,425.00 FEET OF THE WEST HALF OF SECTION 29, TOWNSHIP 2 SOUTH, RANGE 5 EAST, SAN BERNARDINO BASE AND MERIDIAN, IN THE CITY OF DESERT HOT SPRINGS, COUNTY OF RIVERSIDE, STATE OF CALIFORNIA, AS SHOWN BY UNITED STATES GOVERNMENT SURVEY, EXCEPT THAT PORTION LYING SOUTH OF THE CENTER LINE OF SECTION 29, TOWNSHIP 2 SOUTH, RANGE 5 EAST, SAN BERNARDINO BASE AND MERIDIAN.

THE SOUTHERLY 3,668.20 FEET OF THE EASTERLY 475.00 FEET OF THE WESTERLY 1,425.00 FEET OF THE WEST HALF OF SECTION 29, TOWNSHIP 2 SOUTH, RANGE 5 EAST, SAN BERNARDINO BASE AND MERIDIAN, IN THE CITY OF DESERT HOT SPRINGS, COUNTY OF RIVERSIDE, STATE OF CALIFORNIA, AS SHOWN BY UNITED STATES GOVERNMENT SURVEY, EXCEPT THAT PORTION LYING SOUTH OF THE CENTER LINE OF SECTION 29, TOWNSHIP 2 SOUTH, RANGE 5 EAST, SAN BERNARDINO BASE AND MERIDIAN.

THE SOUTHERLY 3,668.20 FEET OF THE EASTERLY 475.00 FEET OF THE WESTERLY 1,425.00 FEET OF THE WEST HALF OF SECTION 29, TOWNSHIP 2 SOUTH, RANGE 5 EAST, SAN BERNARDINO BASE AND MERIDIAN, IN THE CITY OF DESERT HOT SPRINGS, COUNTY OF RIVERSIDE, STATE OF CALIFORNIA, AS SHOWN BY UNITED STATES GOVERNMENT SURVEY, EXCEPT THAT PORTION LYING SOUTH OF THE CENTER LINE OF SECTION 29, TOWNSHIP 2 SOUTH, RANGE 5 EAST, SAN BERNARDINO BASE AND MERIDIAN.

THE SOUTHERLY 3,668.20 FEET OF THE EASTERLY 475.00 FEET OF THE WESTERLY 1,425.00 FEET OF THE WEST HALF OF SECTION 29, TOWNSHIP 2 SOUTH, RANGE 5 EAST, SAN BERNARDINO BASE AND MERIDIAN, IN THE CITY OF DESERT HOT SPRINGS, COUNTY OF RIVERSIDE, STATE OF CALIFORNIA, AS SHOWN BY UNITED STATES GOVERNMENT SURVEY, EXCEPT THAT PORTION LYING SOUTH OF THE CENTER LINE OF SECTION 29, TOWNSHIP 2 SOUTH, RANGE 5 EAST, SAN BERNARDINO BASE AND MERIDIAN.

THE SOUTHERLY 3,668.20 FEET OF THE EASTERLY 475.00 FEET OF THE WESTERLY 1,425.00 FEET OF THE WEST HALF OF SECTION 29, TOWNSHIP 2 SOUTH, RANGE 5 EAST, SAN BERNARDINO BASE AND MERIDIAN, IN THE CITY OF DESERT HOT SPRINGS, COUNTY OF RIVERSIDE, STATE OF CALIFORNIA, AS SHOWN BY UNITED STATES GOVERNMENT SURVEY, EXCEPT THAT PORTION LYING SOUTH OF THE CENTER LINE OF SECTION 29, TOWNSHIP 2 SOUTH, RANGE 5 EAST, SAN BERNARDINO BASE AND MERIDIAN.

THE SOUTHERLY 3,668.20 FEET OF THE EASTERLY 475.00 FEET OF THE WESTERLY 1,425.00 FEET OF THE WEST HALF OF SECTION 29, TOWNSHIP 2 SOUTH, RANGE 5 EAST, SAN BERNARDINO BASE AND MERIDIAN, IN THE CITY OF DESERT HOT SPRINGS, COUNTY OF RIVERSIDE, STATE OF CALIFORNIA, AS SHOWN BY UNITED STATES GOVERNMENT SURVEY, EXCEPT THAT PORTION LYING SOUTH OF THE CENTER LINE OF SECTION 29, TOWNSHIP 2 SOUTH, RANGE 5 EAST, SAN BERNARDINO BASE AND MERIDIAN.

LEGEND

(720)	EXIST. CONTOURS
(222.36)	EXIST. ELEVATIONS
⬆	PROPOSED ELEVATIONS
⬆	PROPOSED CATCH BASIN
FS	FINISHED SURFACE
HP	HIGH POINT
LP	LOW POINT

CITY OF DESERT HOT SPRINGS
TENTATIVE TRACT MAP NO. 37300

CLIENT:

Walton Development
Walton Development and Management, Southwest USA
4800 N. Scottsdale Road, Suite 4000 | Scottsdale, AZ 85251

REV.	DESCRIPTION	DATE	BY
------	-------------	------	----

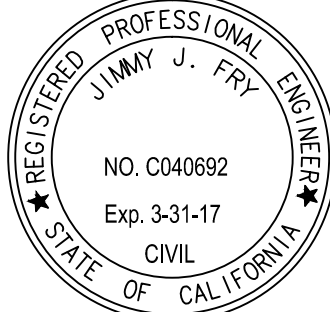

Ludwig Engineering
ASSOCIATES, INC.

109 East Third Street
San Bernardino, CA 92410
Phone: (909) 884-5217
Fax: (909) 888-0153

16352 Stevens Road, Ste. B
Lake Havasu City, AZ 86403
Phone: (908) 665-6500
Fax: (908) 665-6501

Tuesday, March 14, 2017 8:54:10 AM



VICINITY MAP
N.T.S.



SITE INDEX
N.T.S.

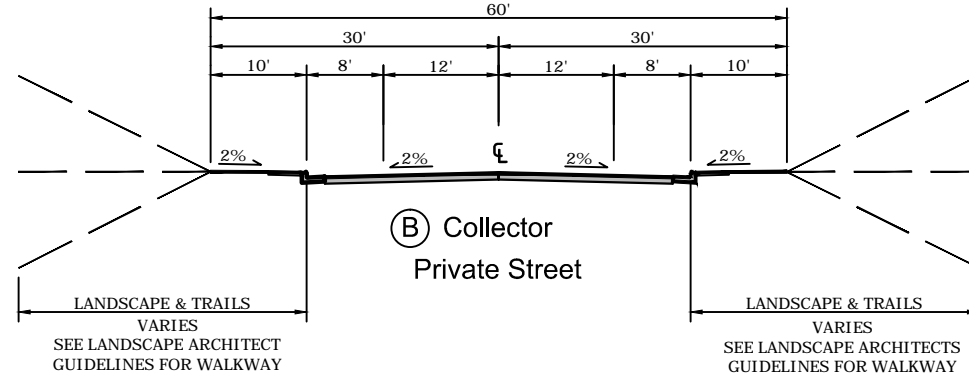

Collector Private Street

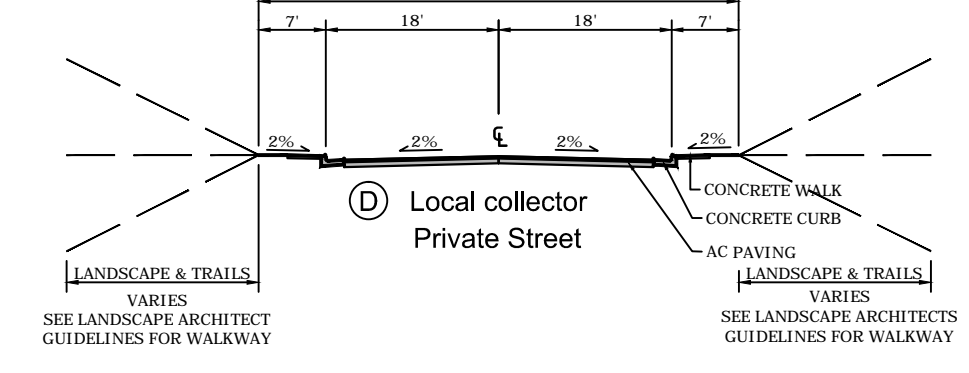

Local collector Private Street

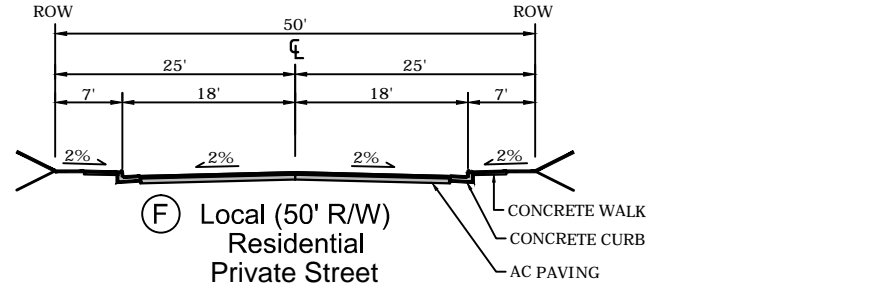

Local (50' RW) Residential Private Street

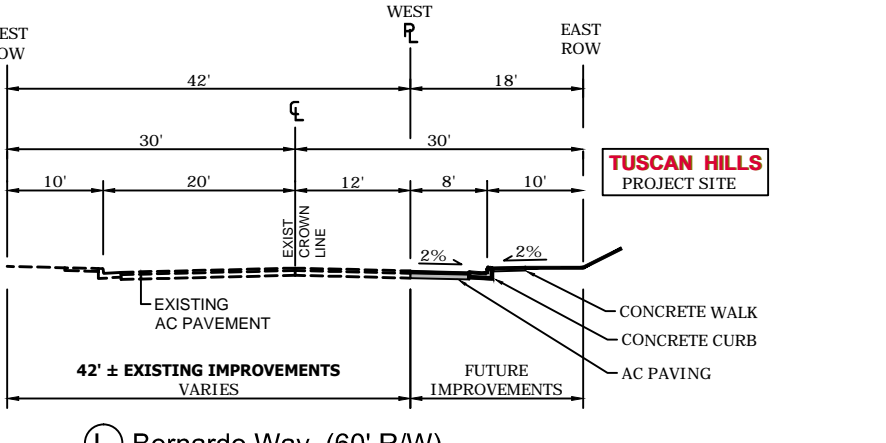

Bernardo Way (60' RW) Public Street

SHEET

OF

1

1

C-1