

BOUNDARY MAP
SPECIAL PUBLIC SAFETY TAX AREA
ZONE 45 (WATERMARKE HOMES, LLC)
CITY OF DESERT HOT SPRINGS

COUNTY OF RIVERSIDE, STATE OF CALIFORNIA
S²of SW⁴, SEC. 24, T.2S., R.4E.

LEGEND

- ZONE 45 BOUNDARY
- PARCEL LINES
- XXX-XXX-XXX ASSESSOR PARCEL NUMBER

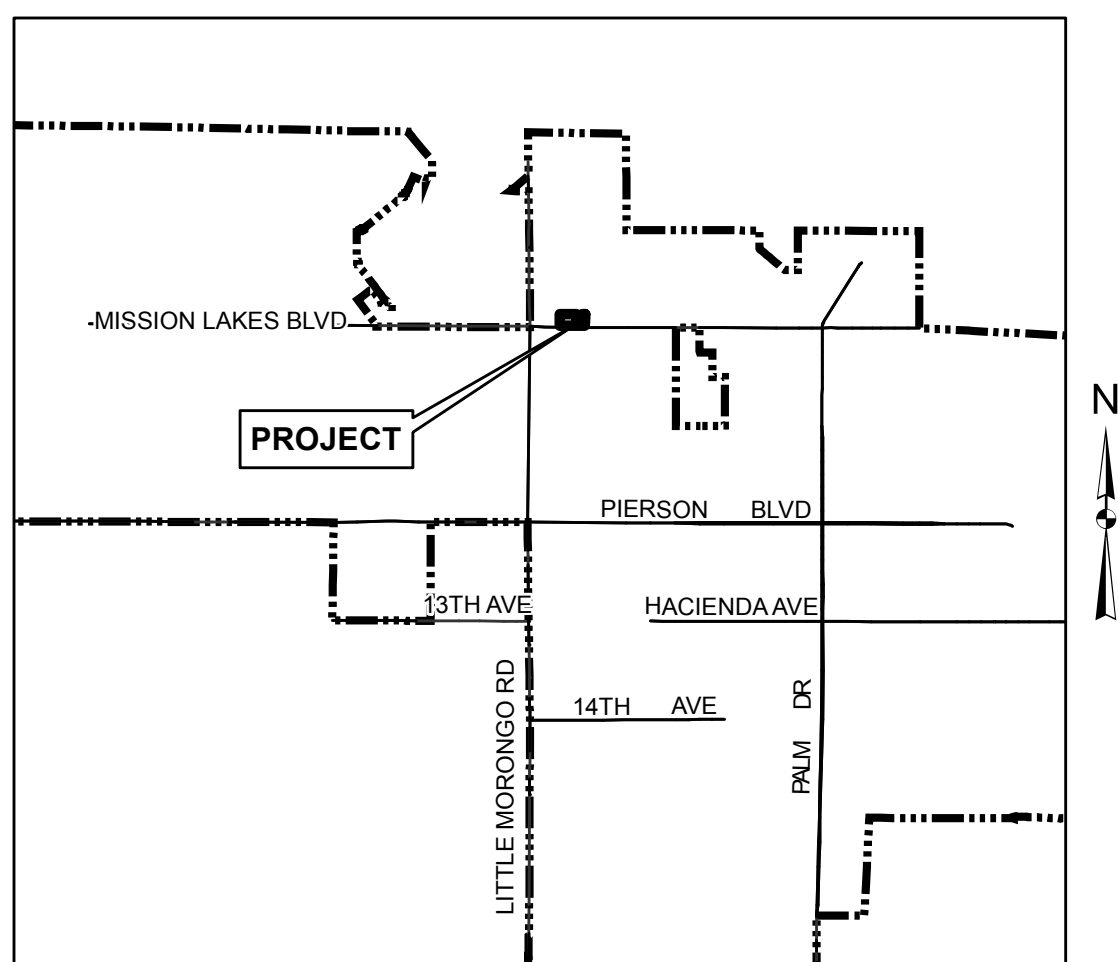
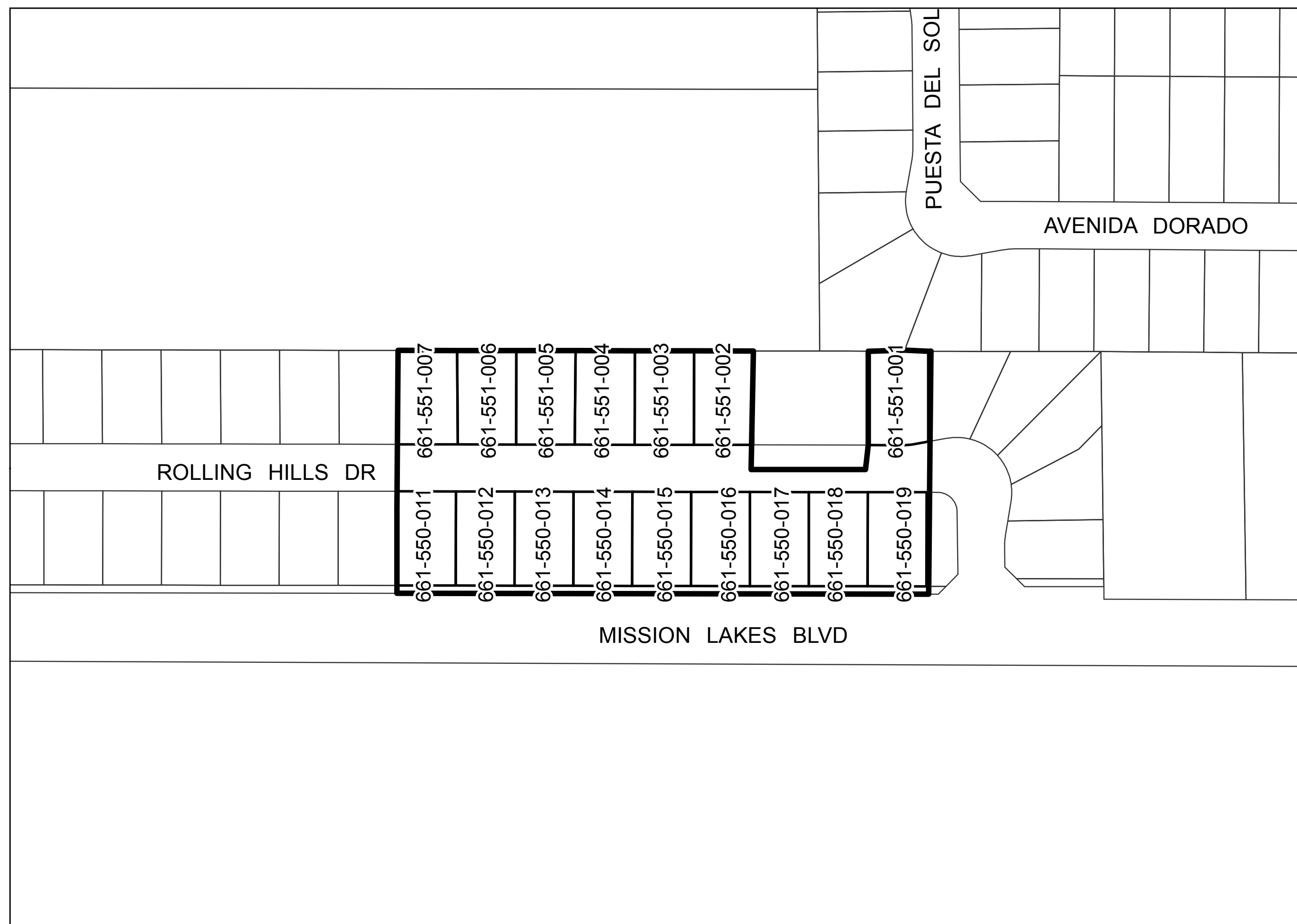

VICINITY MAP
NOT TO SCALE

