



# BOUNDARY MAP

SPECIAL PUBLIC SAFETY TAX AREA  
ZONE 45 (WATERMARKE HOMES, LLC)  
CITY OF DESERT HOT SPRINGS

COUNTY OF RIVERSIDE, STATE OF CALIFORNIA  
S<sup>2</sup>of SW<sup>4</sup>, SEC. 24, T.2S., R.4E.

### LEGEND

-  ZONE 45 BOUNDARY
-  PARCEL LINES
- XXX-XXX-XXX ASSESSOR PARCEL NUMBER

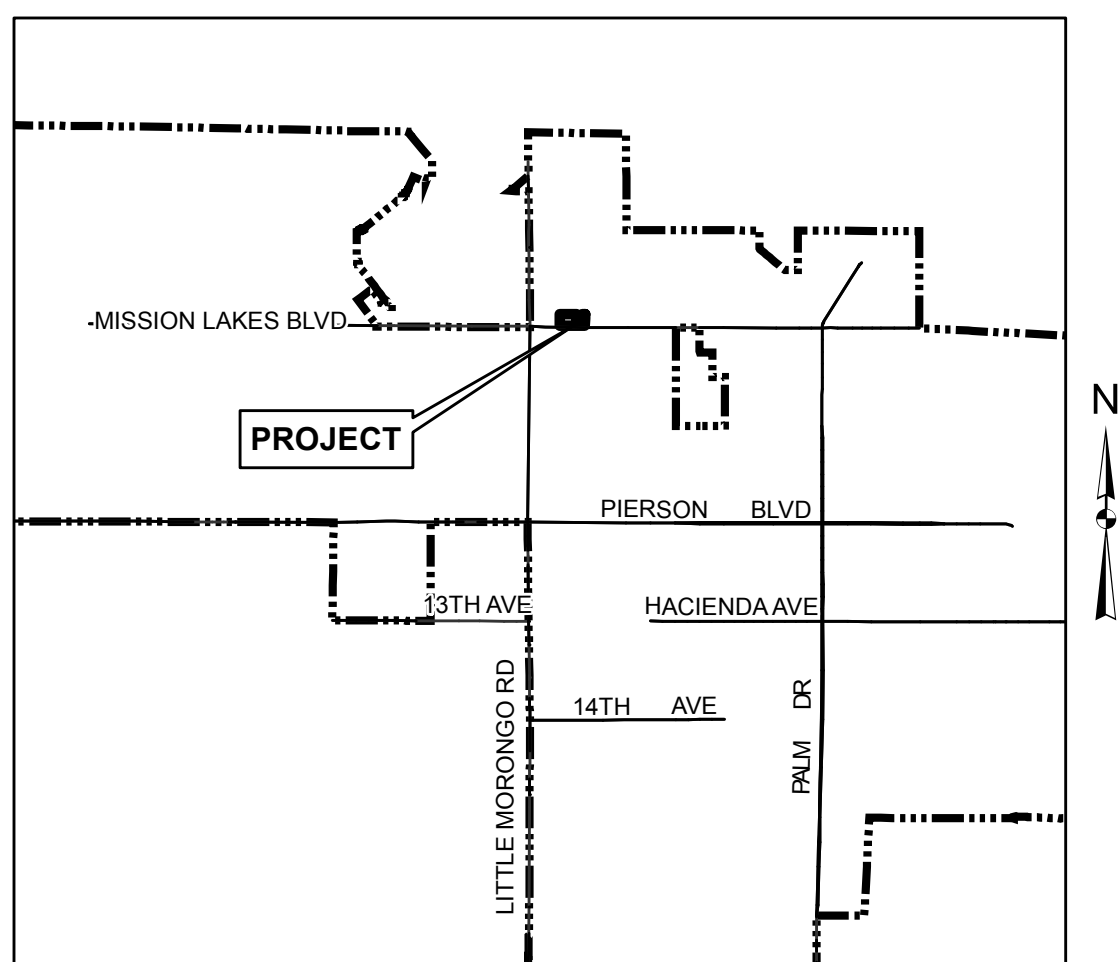
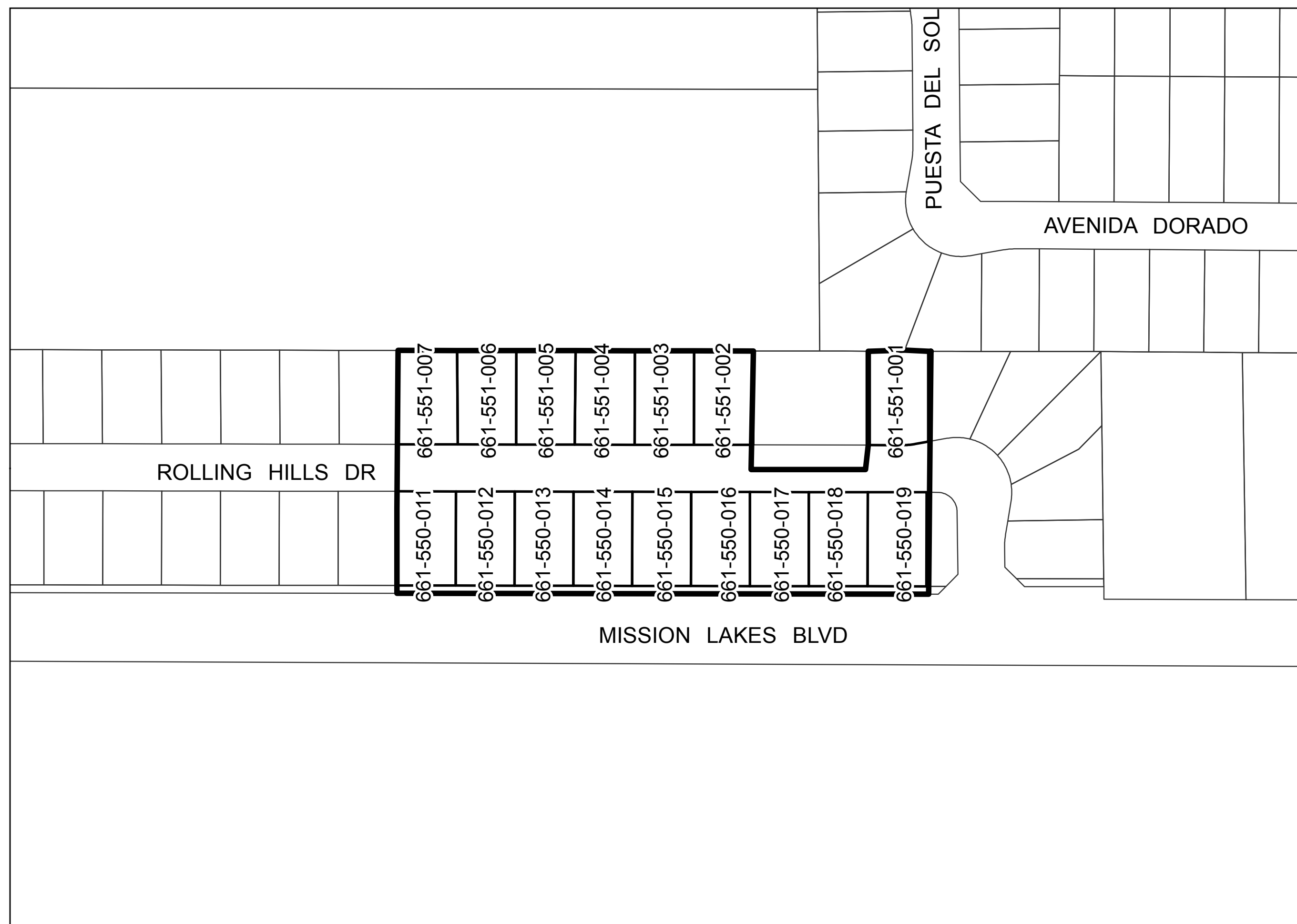

VICINITY MAP  
NOT TO SCALE

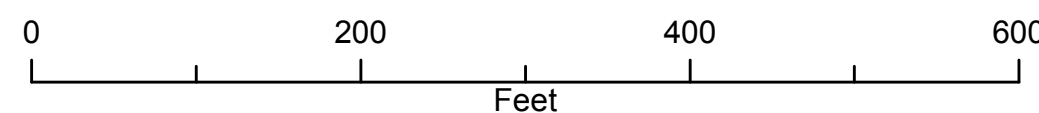

THIS BOUNDARY MAP CORRECTLY SHOWS THE BOUNDARIES OF ZONE 45 (WATERMARKE HOMES, LLC). FOR DETAILS CONCERNING THE LINES AND DIMENSIONS OF LOTS OR PARCELS REFER TO THE COUNTY ASSESSOR'S MAPS FOR FISCAL YEAR 2018-2019.