



PHOTOGRAPH NO. 1

SOUTH WEST CORNER



PHOTOGRAPH NO. 2

NORTH WEST CORNER



PHOTOGRAPH NO. 3

NORTH EAST CORNER



PHOTOGRAPH NO. 4

SOUTH EAST CORNER

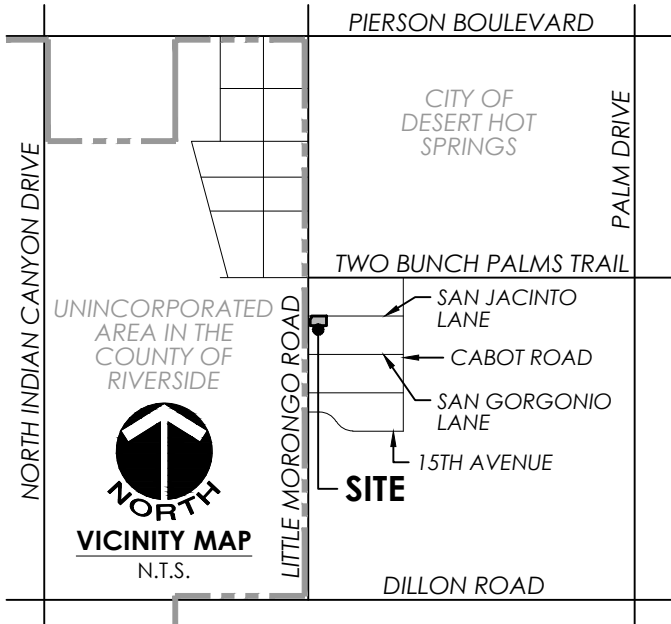

IN THE CITY OF DESERT HOT SPRINGS, COUNTY OF RIVERSIDE, STATE OF CALIFORNIA

# CONDITIONAL USE PERMIT EXISTING SITE PHOTOGRAPHS

EXHIBIT DATE: SEPTEMBER 29, 2017

## DATA TABLE

APPLICANT:	SMOOTH EVERLASTING, INC.		
ADDRESS:	7034 CALCATERRA DRIVE SAN JOSE, CALIFORNIA 95120		
CONTACT:	KENNETH MOODY & VICKI JARVIS	TELEPHONE:	(310) 750-5860
LAND OWNER:	JARVIS VICKI S LIVING TRUST		
ADDRESS:	42215 WASHINGTON STREET - SUITE F-362 PALM DESERT, CALIFORNIA 92211		
CONTACT:	MSA CONSULTING INC.	TELEPHONE:	(760) 320-9811
EXHIBIT PREPARER:	MSA CONSULTING, INC.		
ADDRESS:	34200 BOB HOPE DRIVE RANCHO MIRAGE, CALIFORNIA 92270		
CONTACT:	PAUL DEPALATIS, AICP	TELEPHONE:	(760) 320-9811

ASSESSOR'S PARCEL NUMBER: 665-030-061

LEGAL DESCRIPTION: PORTION OF THE NORTH HALF OF PARCEL 15 R.S. 21/55 SECTION 1, TOWNSHIP 3 SOUTH, RANGE 4 EAST, SAN BERNARDINO MERIDIAN.

- GENERAL NOTES:**
1. Conditional Use Permit Intent: Medical Marijuana Cultivation in accordance with Desert Hot Springs Municipal Code Chapters 5.50 and 17.180 including plant cloning, cultivation, trimming, drying, extraction, and processing of oils and butters, CO2 equipment use for enhanced plant growth and extraction, product packaging and shipping.
  2. Conditional Use Permit Intent: This facility has been designed in accordance with Desert Hot Springs regulations governing the cultivation of medical marijuana (Municipal Code Chapter 5.50 and 17.180), current state laws codified in the Compassionate Use Act of 1996 (California Health and Safety Code Sections 11362.7 through 11362.83), the California Attorney General's Guidelines for the Security and Non-Diversion of Marijuana Growth for Medical Use (issued in August, 2008) and the Medicinal and Adult-Use Cannabis Regulation and Safety Act (SB 94). The requested use, site layout, and site operations as well as any related activities, such as transportation, manufacturing, and testing are designed for full compliance and vesting under both existing and potential future City and State laws governing the cultivation of medical marijuana.
  3. Site Improvements will be constructed at one time, but building construction may be phased in response to market demand.



INDEX MAP  
SCALE: 1" = 50'

Legend:

# Photograph ID, Location & Direction Symbol