



PHOTOGRAPH NO. 1 SOUTH WEST CORNER



PHOTOGRAPH NO. 2 NORTH WEST CORNER



PHOTOGRAPH NO. 3 NORTH EAST CORNER



PHOTOGRAPH NO. 4 SOUTH EAST CORNER

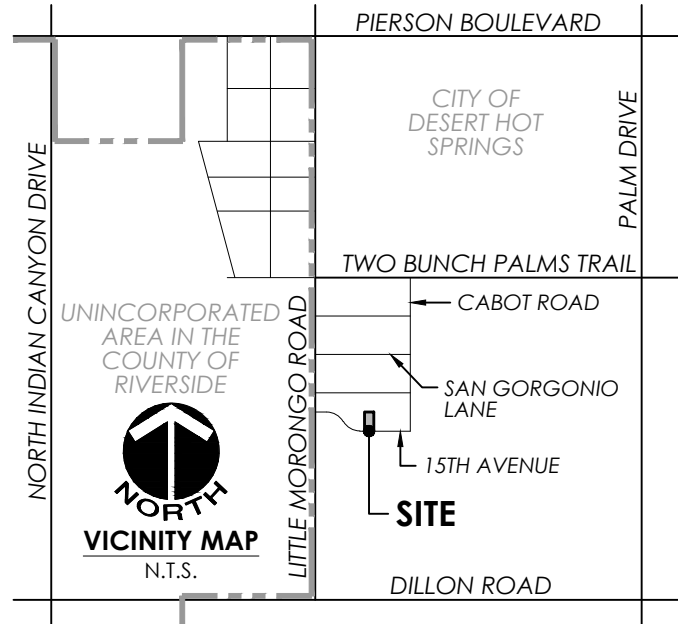

IN THE CITY OF DESERT HOT SPRINGS, COUNTY OF RIVERSIDE, STATE OF CALIFORNIA

CONDITIONAL USE PERMIT  
EXISTING SITE PHOTOGRAPHS

EXHIBIT DATE: SEPTEMBER 12, 2017

DATA TABLE

APPLICANT/ LAND OWNER:	REDSHIELD CAPITAL, LLC		
ADDRESS:	2031 EAST FOOTHILL BOULEVARD PASADENA, CALIFORNIA 91107		
CONTACT:	SPENCER JIANAN LI	TELEPHONE:	(626) 297-0676
EXHIBIT PREPARER:	MSA CONSULTING, INC.		
ADDRESS:	34200 BOB HOPE DRIVE RANCHO MIRAGE, CALIFORNIA 92270		
CONTACT:	PAUL DEPALATIS, AICP	TELEPHONE:	(760) 320-9811
ASSESSOR'S PARCEL NUMBER:	665-050-018		
LEGAL DESCRIPTION:	THE WEST HALF OF PARCEL 53 RS 21/55 SECTION 1, TOWNSHIP 3 SOUTH, RANGE 4 EAST, SAN BERNARDINO MERIDIAN.		

- Conditional Use Permit Intent:
1. Medical Marijuana Cultivation in accordance with Desert Hot Springs Municipal Code Chapters 5.50 and 17.180 including plant cloning, cultivation, trimming, drying, extraction, and processing of oils and butters, CO2 equipment use for enhanced plant growth and extraction, product packaging and shipping.
  2. This facility has been designed in accordance with Desert Hot Springs regulations governing the cultivation of medical marijuana (Municipal Code Chapter 5.50 and 17.180), current state laws codified in the Compassionate Use Act of 1996 (California Health and Safety Code Sections 11362.7 through 11362.83), the California Attorney General's Guidelines for the Security and Non-Diversion of Marijuana Growth for Medical Use (Issued in August, 2008) and the Medical Marijuana Regulation and Safety Act (AB 2661). The requested use, site layout, and site operations as well as any related activities, such as transportation, manufacturing, and testing are designed for full compliance and vesting under both existing and potential future City and State laws governing the cultivation of medical marijuana.

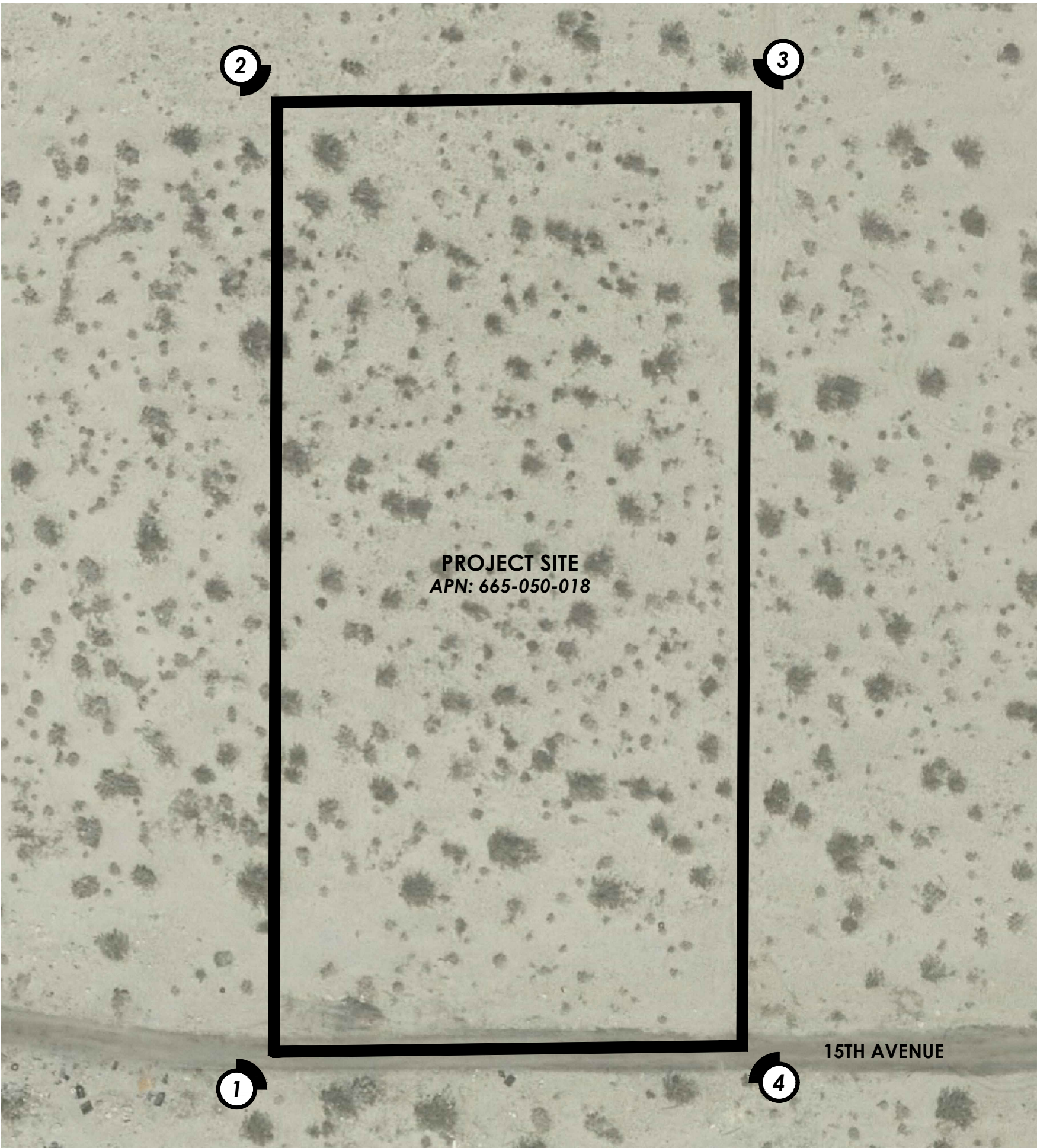

INDEX MAP  
SCALE: 1" = 40'

Legend:  
# Photograph ID, Location & Direction Symbol