

BOUNDARY MAP
SPECIAL PUBLIC SAFETY TAX AREA
ZONE 28 (DHS FACILITIES LLC)
CITY OF DESERT HOT SPRINGS

LEGEND

- ZONE 28 BOUNDARY
- PARCEL LINES
- XXX-XXX-XXX ASSESSOR PARCEL NUMBER

COUNTY OF RIVERSIDE, STATE OF CALIFORNIA
SW⁴ OF SW⁴, SEC. 36, T.2S., R.4E.

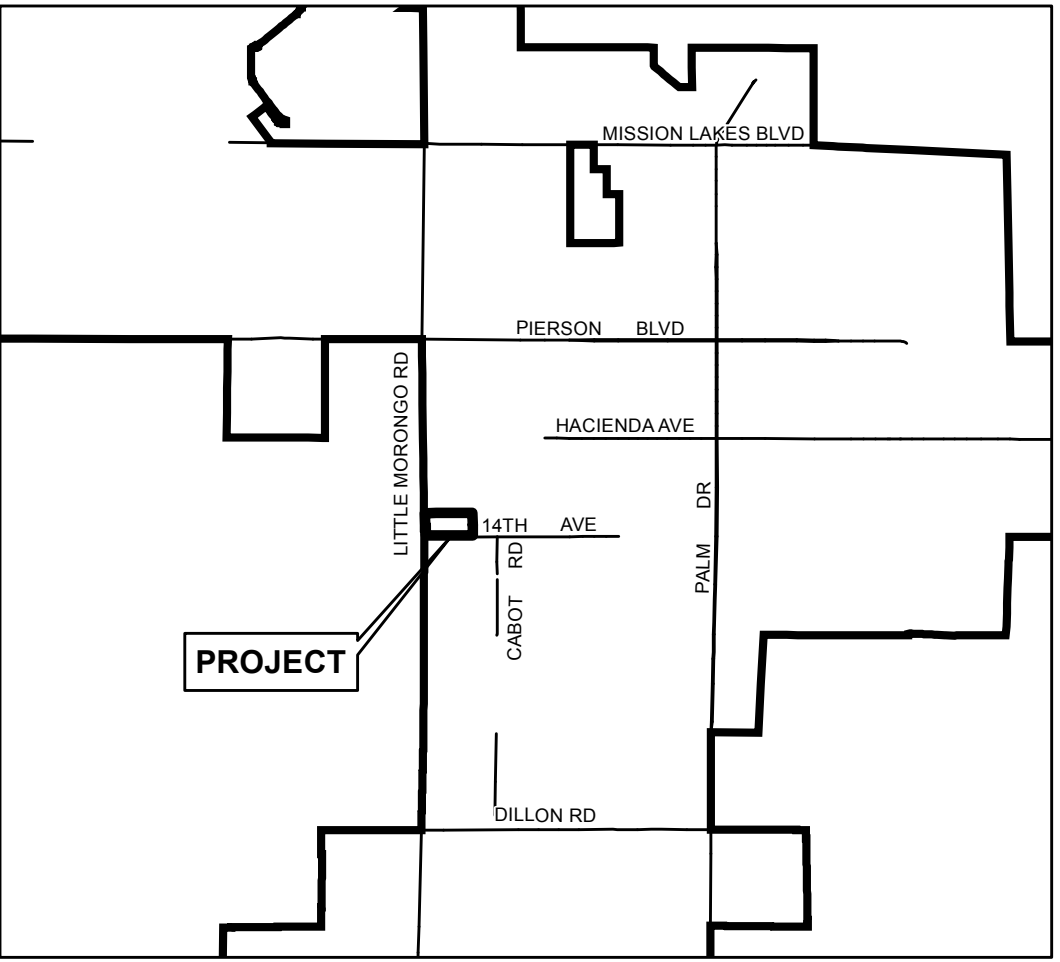

VICINITY MAP
NOT TO SCALE

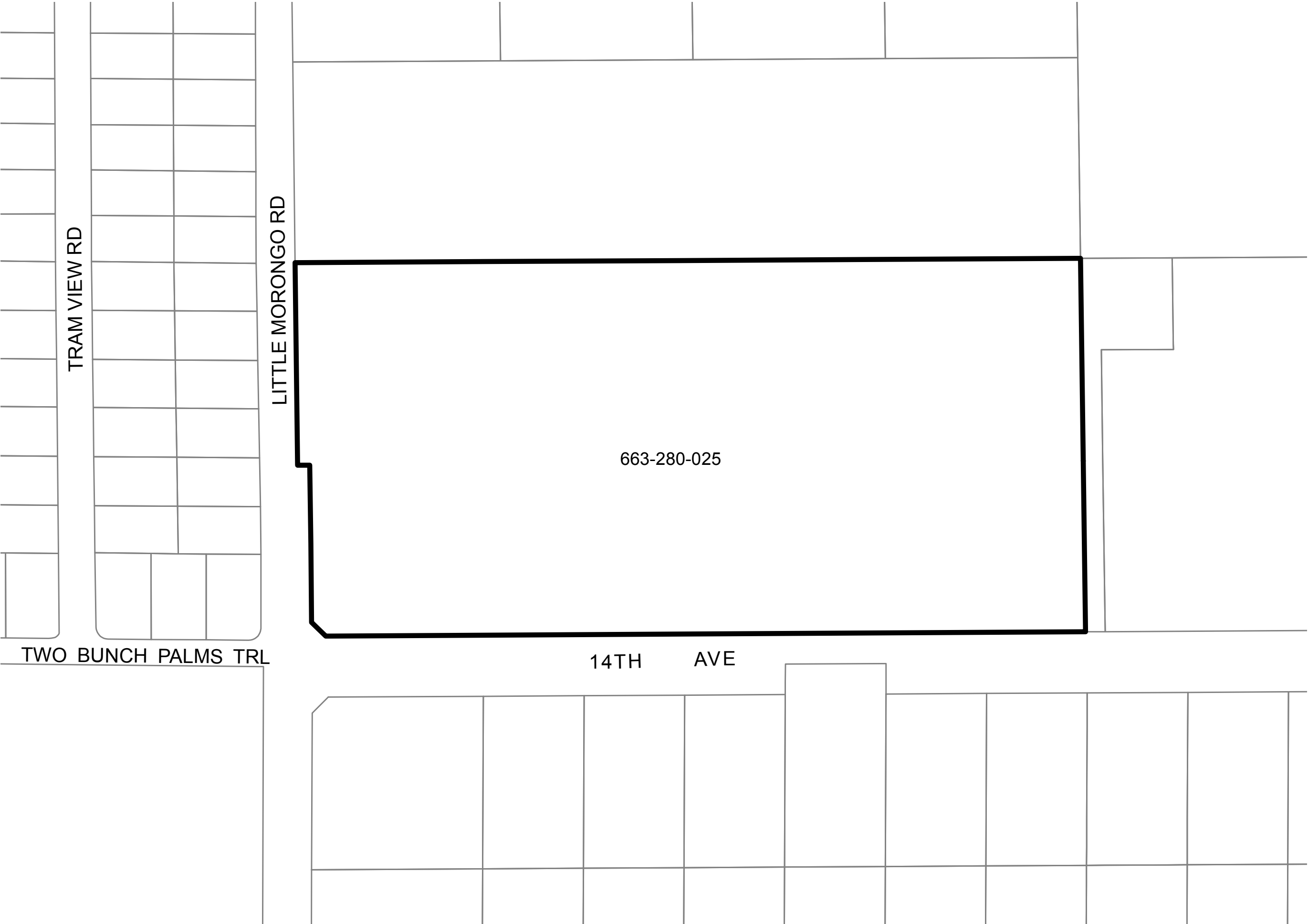

1 inch = 150 feet