



PHOTOGRAPH NO. 1: NORTH WEST CORNER



PHOTOGRAPH NO. 2: NORTH EAST CORNER



PHOTOGRAPH NO. 3: SOUTH EAST CORNER



PHOTOGRAPH NO. 4: SOUTH WEST CORNER

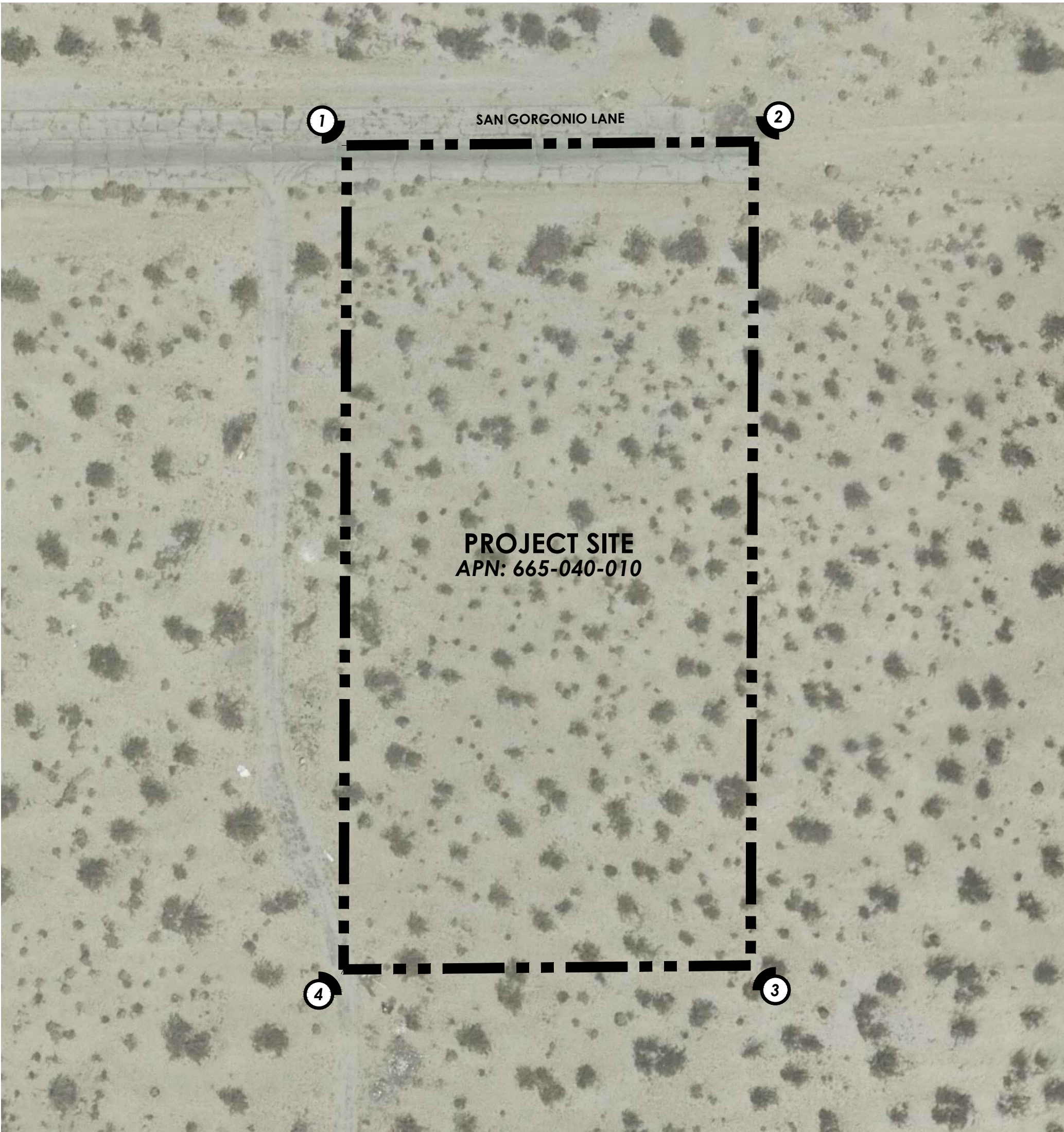

INDEX MAP
SCALE: 1" = 40'

Legend:



Photograph ID, Location & Direction Symbol

IN THE CITY OF DESERT HOT SPRINGS, COUNTY OF RIVERSIDE, STATE OF CALIFORNIA

CONDITIONAL USE PERMIT EXISTING SITE PHOTOGRAPHS

EXHIBIT DATE: JANUARY 31, 2017

DATA TABLE

APPLICANT / LAND OWNER:	MIRO LLC.		
ADDRESS:	1679 SOUTH DUPONT HIGHWAY - SUITE 100 DOVER, DELAWARE 19901		
CONTACT:	MICHAEL BUONO	TELEPHONE:	(908) 727-0057
EXHIBIT PREPARER:	MSA CONSULTING, INC.		
ADDRESS:	34200 BOB HOPE DRIVE RANCHO MIRAGE, CALIFORNIA 92270		
CONTACT:	PAUL DEPALATIS, AICP	TELEPHONE:	(760) 320-9811
ASSESSOR'S PARCEL NUMBER:	665-040-010		
LEGAL DESCRIPTION:	A PORTION OF PARCEL 30 RS 25/84 SECTION 1, TOWNSHIP 3 SOUTH, RANGE 4 EAST, SAN BERNARDINO BASE & MERIDIAN		

Conditional Use Permit Intent:

1. Medical Marijuana Cultivation in accordance with Desert Hot Springs Municipal Code Chapters 5.50 and 17.180 including plant cloning, cultivation, trimming, drying, extraction, and processing of oils and butters, CO2 equipment use for enhanced plant growth and extraction, product packaging and shipping.
2. This facility has been designed in accordance with Desert Hot Springs regulations governing the cultivation of medical marijuana (Municipal Code Chapter 5.50 and 17.180), current state laws codified in the Compassionate Use Act of 1996 (California Health and Safety Code Sections 11362.7 through 11362.83), the California Attorney General's Guidelines for the Security and Non-Diversion of Marijuana Growth for Medical Use (Issued in August, 2008) and the Medical Marijuana Regulation and Safety Act (AB 266). The requested use, site layout, and site operations as well as any related activities, such as transportation, manufacturing, and testing are designed for full compliance and vesting under both existing and potential future City and State laws governing the cultivation of medical marijuana.

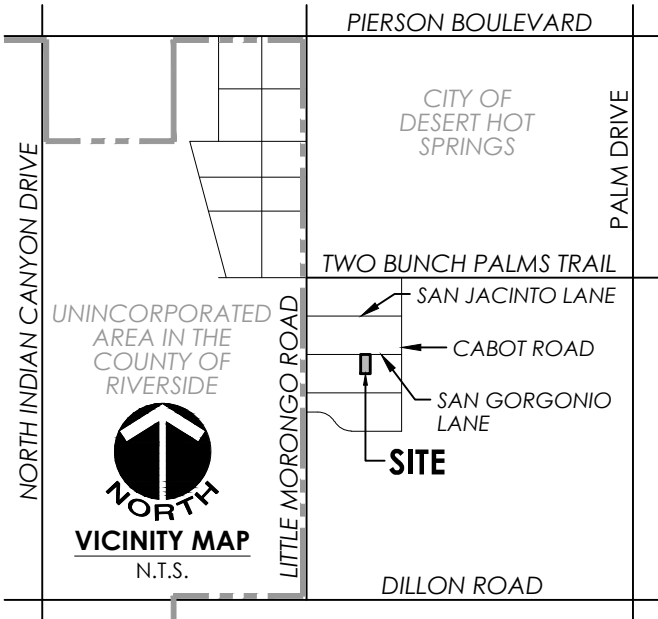

MSA CONSULTING, INC.
PLANNING ■ CIVIL ENGINEERING ■ LAND SURVEYING

34200 BOB HOPE DRIVE ■ RANCHO MIRAGE ■ CA 92270
TELEPHONE (760) 320-9811 ■ FAX (760) 323-7893