



PHOTOGRAPH NO. 1: SOUTH WEST CORNER



PHOTOGRAPH NO. 2: NORTH WEST CORNER



PHOTOGRAPH NO. 3: NORTH EAST CORNER



PHOTOGRAPH NO. 4: SOUTH EAST CORNER

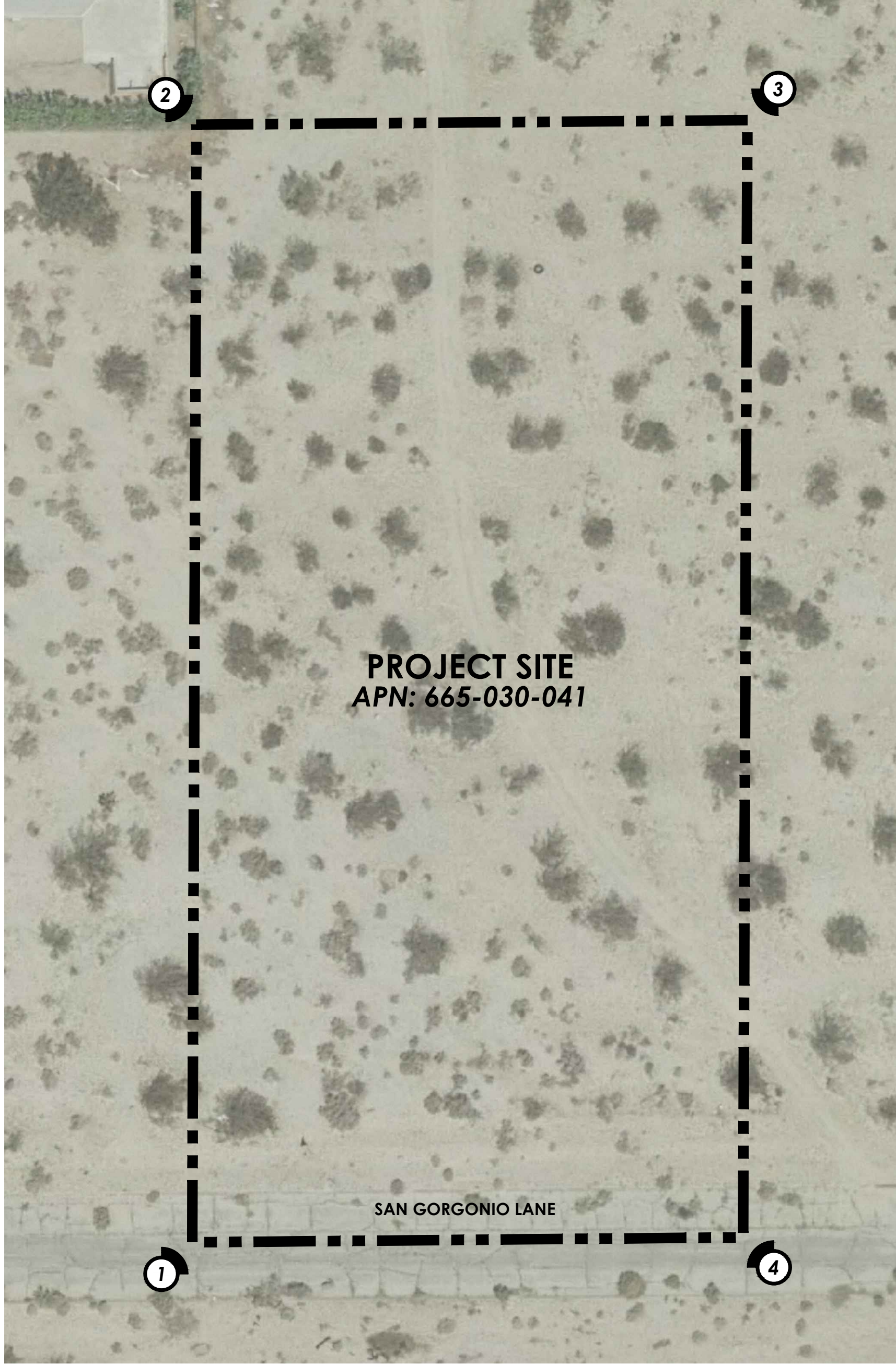

INDEX MAP  
SCALE: 1" = 30'

Legend:



Photograph ID, Location & Direction Symbol

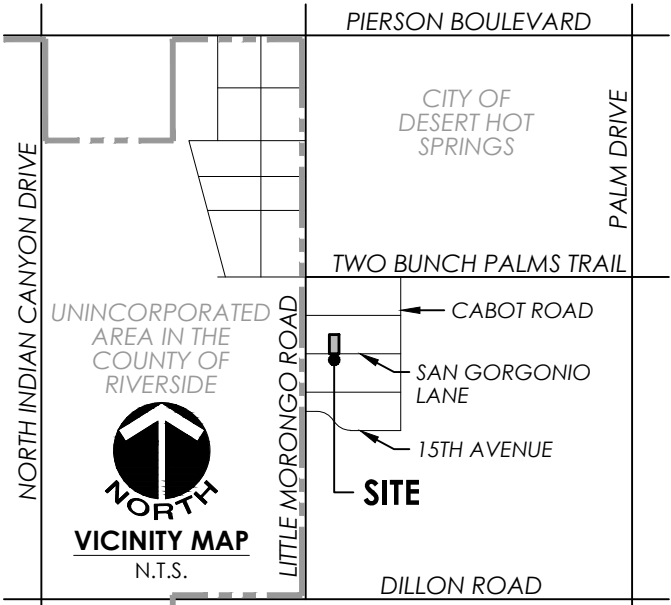

IN THE CITY OF DESERT HOT SPRINGS, COUNTY OF RIVERSIDE, STATE OF CALIFORNIA			
CONDITIONAL USE PERMIT EXISTING SITE PHOTOGRAPHS			
EXHIBIT DATE: MARCH 28, 2017			
DATA TABLE			
APPLICANT / LAND OWNER:	NR TRADING INC.		
ADDRESS:	1276 BOYNTON STREET GLENDALE, CALIFORNIA 91205		
CONTACT:	FELIKS AKOPYAN	TELEPHONE:	(818) 726-1776
EXHIBIT PREPARER:	MSA CONSULTING, INC.		
ADDRESS:	34200 BOB HOPE DRIVE RANCHO MIRAGE, CALIFORNIA 92270		
CONTACT:	PAUL DEPALATIS, AICP	TELEPHONE:	(760) 320-9811
SOURCE OF TOPOGRAPHY:	INLAND AERIAL SURVEYS, INC.		
ADDRESS:	7117 ARLINGTON AVENUE, SUITE "A" RIVERSIDE, CALIFORNIA 92503		
DATE OF TOPOGRAPHY:	2/6/15, 4/1/15, 4/28/15, 2/3/16	TELEPHONE:	(951) 687-4252
ASSESSOR'S PARCEL NUMBER:	665-030-041		
LEGAL DESCRIPTION:	PARCEL 23 RS 25/84 SECTION 1, TOWNSHIP 3 SOUTH, RANGE 4 EAST, SAN BERNARDINO MERIDIAN.		

- Conditional Use Permit Intent:
1. Medical Marijuana Cultivation in accordance with Desert Hot Springs Municipal Code Chapters 5.50 and 17.180 including plant cloning, cultivation, trimming, drying, extraction, and processing of oils and butters, CO2 equipment use for enhanced plant growth and extraction, product packaging and shipping.
  2. This facility has been designed in accordance with Desert Hot Springs regulations governing the cultivation of medical marijuana (Municipal Code Chapter 5.50 and 17.180), current state laws codified in the Compassionate Use Act of 1996 (California Health and Safety Code Sections 11362.7 through 11362.83), the California Attorney General's Guidelines for the Security and Non-Diversion of Marijuana Growth for Medical Use (issued in August, 2008) and the Medical Marijuana Regulation and Safety Act (AB 266). The requested use, site layout, and site operations as well as any related activities, such as transportation, manufacturing, and testing are designed for full compliance and vesting under both existing and potential future City and State laws governing the cultivation of medical marijuana.



MSA CONSULTING, INC.  
PLANNING ■ CIVIL ENGINEERING ■ LAND SURVEYING

34200 BOB HOPE DRIVE ■ RANCHO MIRAGE ■ CA 92270  
TELEPHONE (760) 320-9811 ■ FAX (760) 323-7893