

**BOUNDARY MAP**  
**SPECIAL PUBLIC SAFETY TAX AREA**  
**ZONE 25 (SAN JAC FACILITIES, LLC )**  
**CITY OF DESERT HOT SPRINGS**

**COUNTY OF RIVERSIDE, STATE OF CALIFORNIA**  
**N<sup>2</sup> OF NW<sup>4</sup>, SEC. 1, T.3S., R.4E.**

**LEGEND**

- ZONE 25 BOUNDARY
- ZONE 25 PARCELS
- XXX-XXX-XXX ASSESSOR PARCEL NUMBER

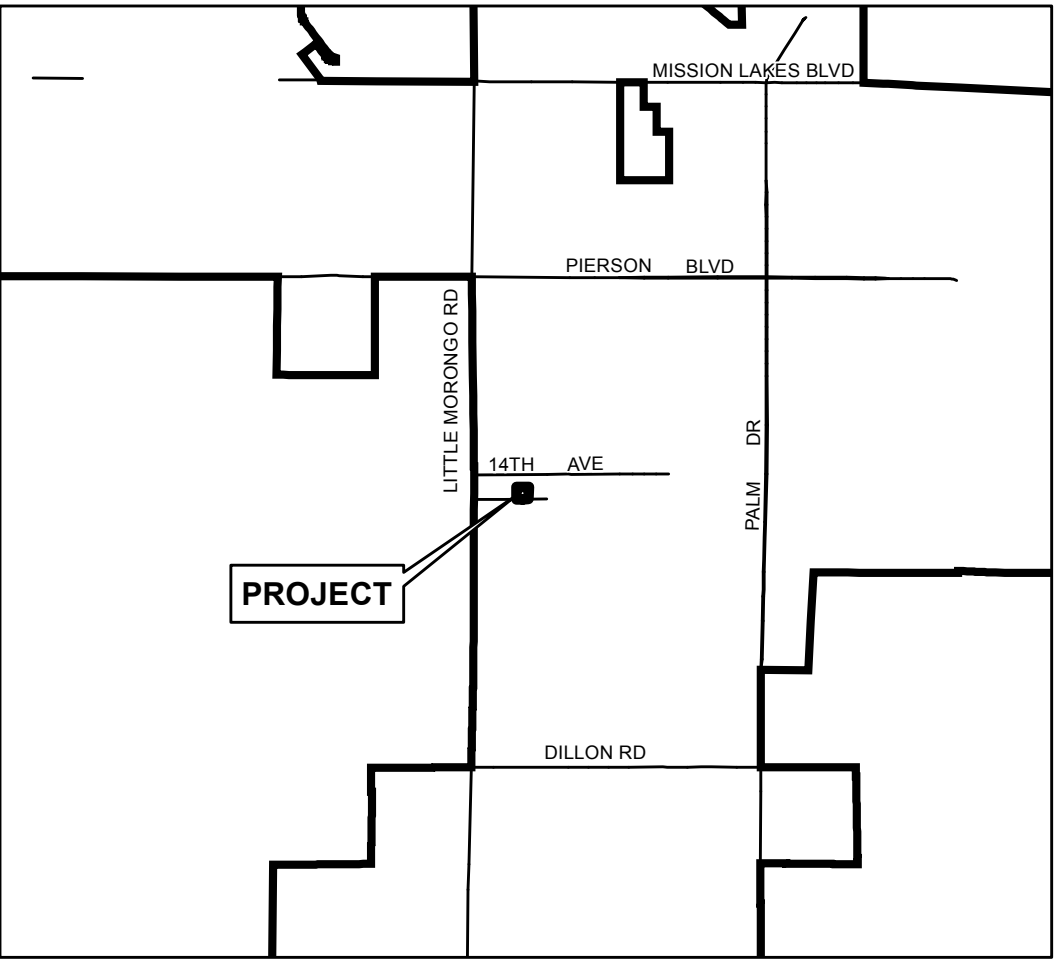

**VICINITY MAP**  
**NOT TO SCALE**

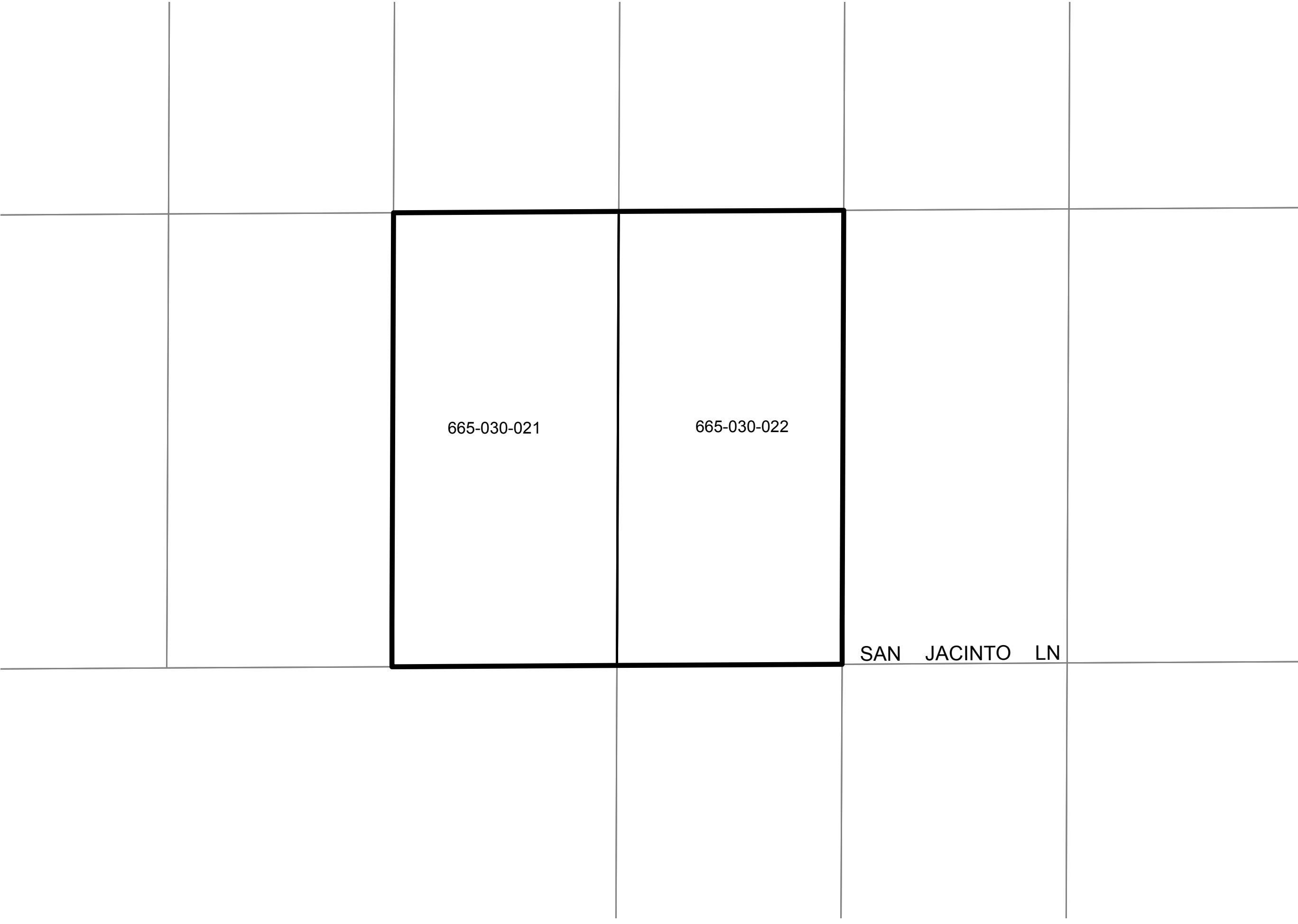

1 inch = 67 feet