

BOUNDARY MAP
SPECIAL PUBLIC SAFETY TAX AREA
ZONE 22 (BUNCH PALMS TRAIL, LLC)
CITY OF DESERT HOT SPRINGS

COUNTY OF RIVERSIDE, STATE OF CALIFORNIA
NE⁴ OF NW⁴, SEC. 1, T.3S., R.4E.

LEGEND

—— ZONE 22 BOUNDARY

XXX-XXX-XXX ASSESSOR PARCEL NUMBER

14TH AVE

CABOT RD

665-030-058

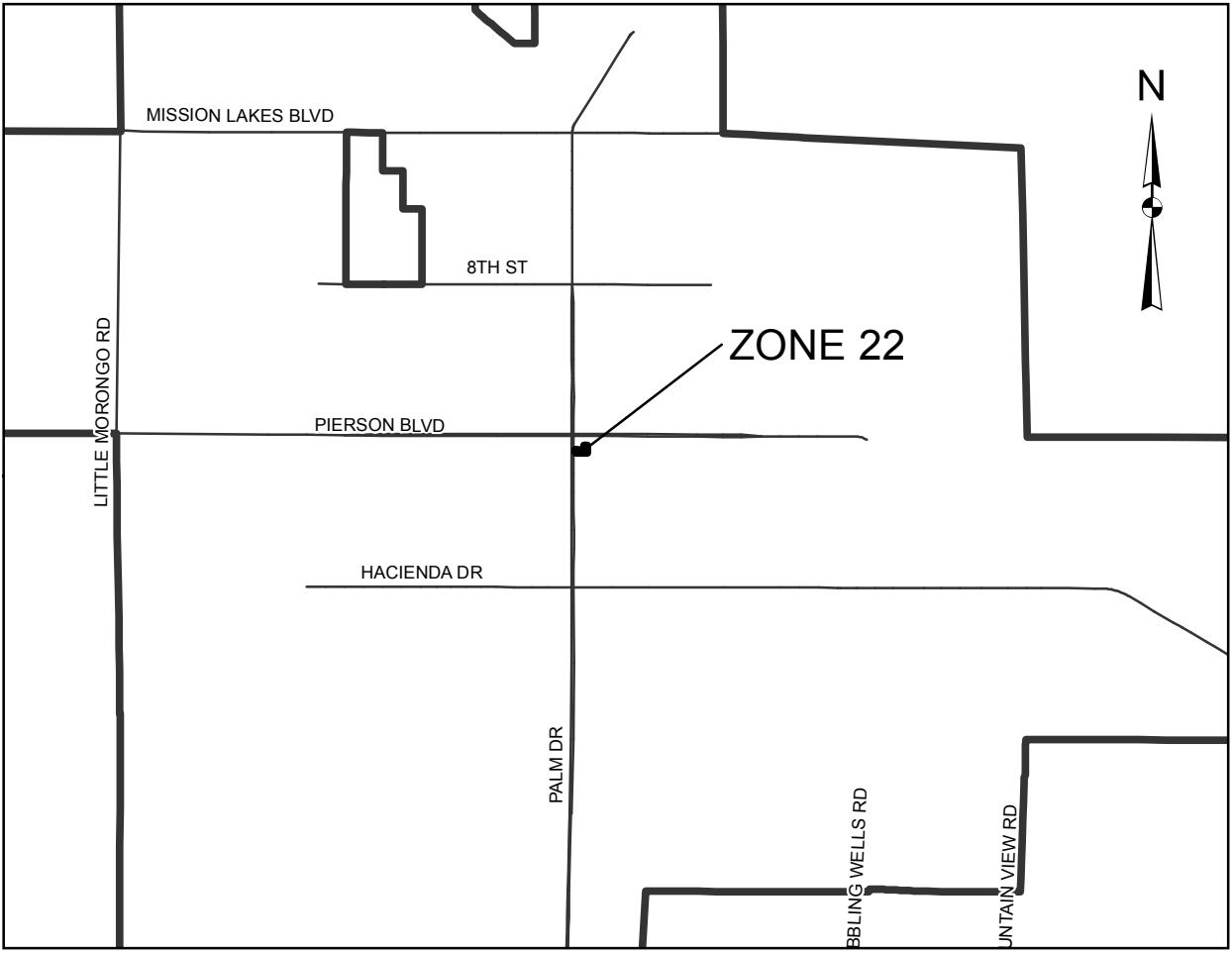

VICINITY MAP
NOT TO SCALE



1 inch = 50 feet