

ANNEXATION MAP NO. 9
COMMUNITY FACILITIES DISTRICT NO. 2010-1 (SERVICES)
CITY OF DESERT HOT SPRINGS
COUNTY OF RIVERSIDE, STATE OF CALIFORNIA

THIS MAP SHOWS THE BOUNDARIES OF AREAS TO BE ANNEXED TO COMMUNITY FACILITIES DISTRICT NO. 2010-1 (SERVICES) OF THE CITY OF DESERT HOT SPRINGS, COUNTY OF RIVERSIDE, STATE OF CALIFORNIA. THE BOUNDARIES OF WHICH COMMUNITY FACILITIES DISTRICT ARE SHOWN AND DESCRIBED ON THE MAP THEREOF WHICH WAS PREVIOUSLY RECORDED ON JUNE 8, 2010, IN BOOK 74 OF MAPS OF ASSESSMENT AND COMMUNITY FACILITIES DISTRICTS AT PAGE 81 AND AS INSTRUMENT NO. 2010-0263725, IN THE OFFICE OF THE COUNTY RECORDER OF THE COUNTY OF RIVERSIDE, STATE OF CALIFORNIA.

I HEREBY CERTIFY THAT THE WITHIN MAP OR AREAS TO BE ANNEXED TO COMMUNITY FACILITIES DISTRICT NO. 2010-1 (SERVICES) OF THE CITY OF DESERT HOT SPRINGS, COUNTY OF RIVERSIDE, STATE OF CALIFORNIA, WAS APPROVED BY THE CITY COUNCIL OF THE CITY OF DESERT HOT SPRINGS AT A REGULAR MEETING THEREOF, HELD ON THE 21st DAY OF MARCH, 2017, BY ITS RESOLUTION NO. 2017-009.

CITY CLERK
CITY OF DESERT HOT SPRINGS

VICINITY MAP
NOT TO SCALE

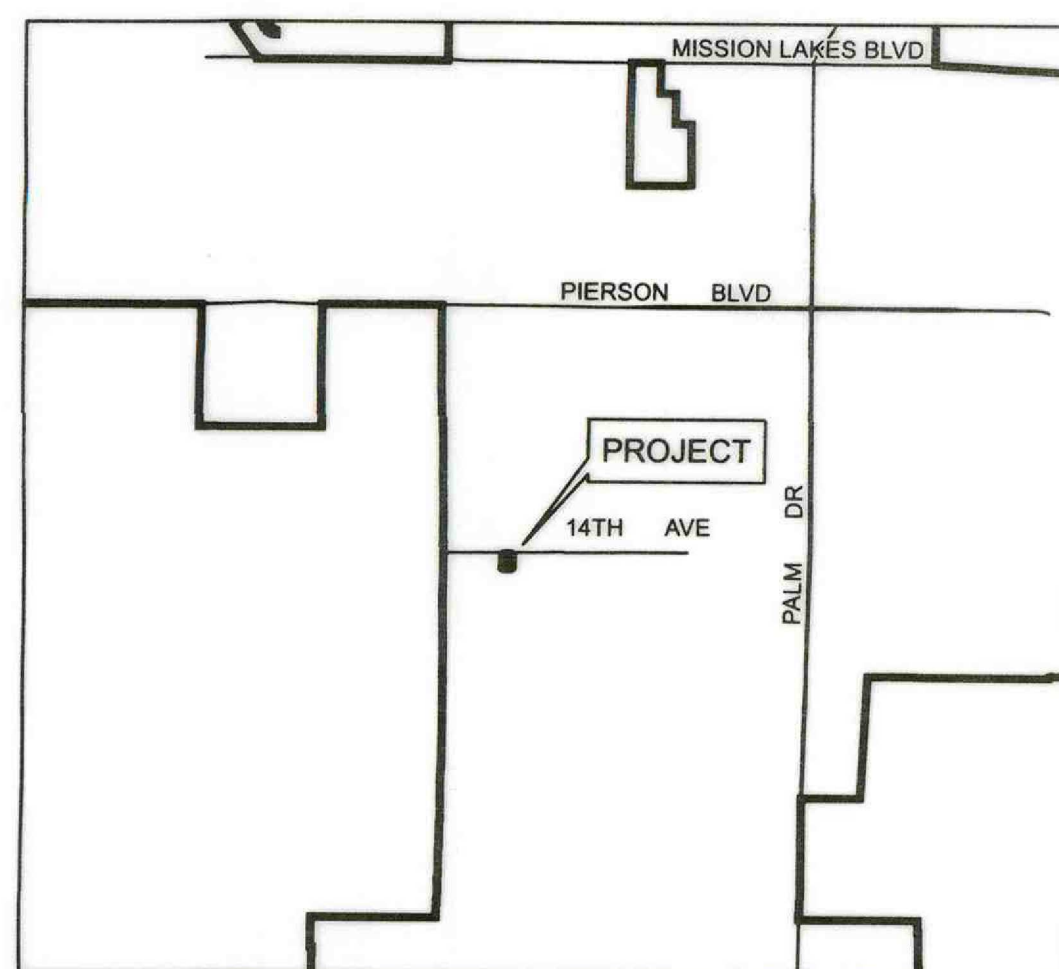

N

1 inch = 50 feet



RECORDED THIS 11th DAY OF April, 2017, AT THE HOUR OF 12:58 O'CLOCK PM, IN IN BOOK 80 PAGE 53 OF MAPS OF ASSESSMENT AND COMMUNITY FACILITIES DISTRICTS IN THE OFFICE OF THE COUNTY RECORDER, IN THE COUNTY OF RIVERSIDE, STATE OF CALIFORNIA.

FEE: \$10.00 NO.: 2017-0144338
PETER ALDANA, ASSESSOR, COUNTY CLERK, RECORDER

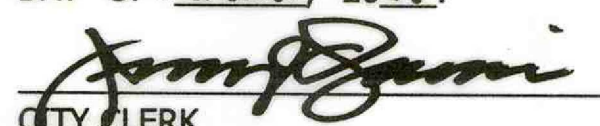
BY: 
DEPUTY

FILED IN THE OFFICE OF THE CITY CLERK, CITY OF DESERT HOT SPRINGS, THIS 21st DAY OF MARCH, 2017.

CITY CLERK
CITY OF DESERT HOT SPRINGS

LEGEND	
	CFD BOUNDARY
	PARCEL LINE
XXX-XXX-XXX	ASSESSOR PARCEL NUMBER