

ABBREVIATIONS

(E)	EAST	NO.	NUMBER
(N)	NORTH	N.T.S.	NOT TO SCALE
(S)	SOUTH	O/H	OVERHEAD
(W)	WEST	OS/PP	OPEN SPACE / PARKS
A.C.	ASPHALT CONCRETE	PED.	PEDESTRIAN
AC	ACREAGE	PG.	PAGE
APN	ASSESSOR'S PARCEL NUMBER	P/L	PROPERTY LINE
BNDRY	BOUNDARY	PROP.	PROPOSED
C/L	CENTERLINE	P.U.E.	PUBLIC UTILITY EASEMENT
C&G	CURB AND GUTTER	R	RADIUS
E/P	EDGE OF PAVEMENT	R/L	LOW DENSITY (RESIDENTIAL)
ESMT.	EASEMENT	R/W	RIGHT OF WAY
EX.	EXISTING	SCE	SOUTHERN CALIFORNIA EDISON
GFA	GROUND FLOOR AREA	SF	SQUARE FEET
MAX.	MAXIMUM	STD.	STANDARD
M.B.	MAP BOOK	TYP.	TYPICAL
MIN.	MINIMUM	UG	UNDERGROUND

LEGEND

---	C	EXISTING CABLE
---	DRN	EXISTING IRRIGATION DRAIN LINE
---	E	EXISTING EASEMENT
---	E	EXISTING ELECTRIC
---	G	EXISTING GAS
---	IRR	EXISTING IRRIGATION
---	LOT	EXISTING LOT LINE
---	EDGE	EXISTING EDGE OF PAVEMENT
---	T	EXISTING TELEPHONE
O/H T		EXISTING OVERHEAD TELEPHONE
R/W		EXISTING RIGHT OF WAY
S		EXISTING SEWER
FM		EXISTING SEWER FORCE MAIN
W		EXISTING WATER
---		PROJECT BOUNDARY
---		PROPOSED AND EXISTING CENTER LINE
---		PROPOSED RIGHT OF WAY

© Copyright 2016
MSA Consulting, Inc.
All Rights Reserved

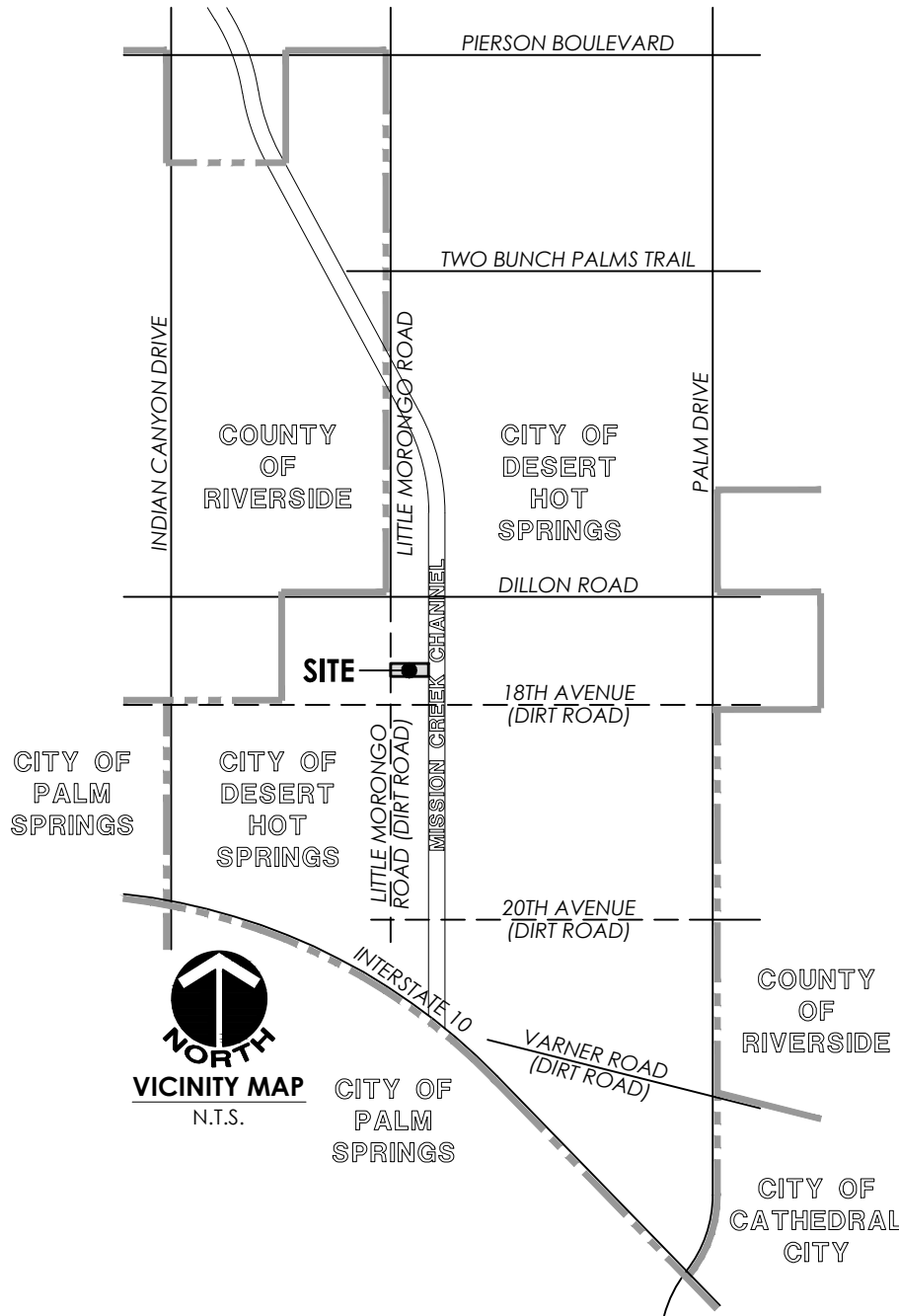
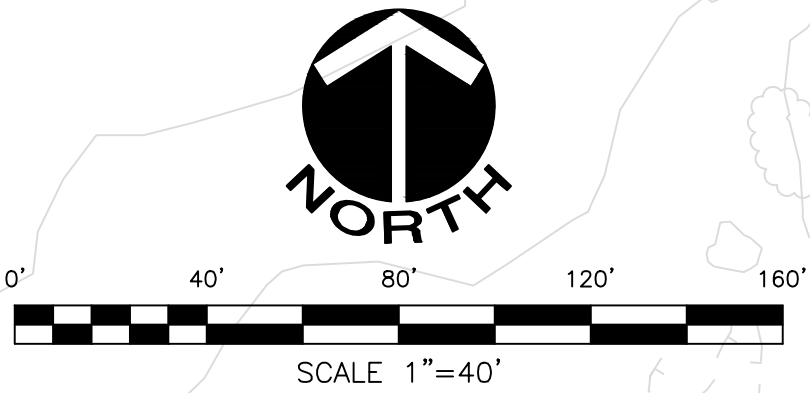

IN THE CITY OF DESERT HOT SPRINGS, COUNTY OF RIVERSIDE, STATE OF CALIFORNIA		
TENTATIVE TRACT MAP NO. 37123		
FOR CONDOMINIUM PURPOSES		
EXHIBIT DATE: MARCH 30, 2016		
DATA TABLE		
APPLICANT / LAND OWNER:	GFARMALABS LIMITED	
ADDRESS:	369 3RD STREET - SUITE 464 SAN RAFAEL, CALIFORNIA 94901	
CONTACT:	DR. CRISTINA GONZALEZ	TELEPHONE: (714) 495-2643
APPLICANT / LAND OWNER:	GFARMALABS LIMITED	
ADDRESS:	369 3RD STREET - SUITE 464 SAN RAFAEL, CALIFORNIA 94901	
CONTACT:	DR. CRISTINA GONZALEZ	TELEPHONE: (714) 495-2643
EXHIBIT PREPARER:	MSA CONSULTING, INC.	
ADDRESS:	34200 BOB HOPE DRIVE RANCHO MIRAGE, CALIFORNIA 92270	
CONTACT:	PAUL DEPALATIS, AICP	TELEPHONE: (760) 320-9811
ASSESSOR'S PARCEL NUMBER:	665-190-017	
LEGAL DESCRIPTION:	A PORTION OF THE SOUTH 1/2 OF THE NORTH 1/2 OF THE SOUTHWEST 1/4 OF THE SOUTHWEST 1/4 OF SECTION 12, TOWNSHIP 3 SOUTH, RANGE 4 EAST, SAN BERNARDINO BASE & MERIDIAN	
LAND USE DATA:	S.F.	ACREAGE
GROSS ACREAGE	298,961 SF	6.86 AC
LITTLE MORONGO ROAD PUBLIC STREET DEDICATION	17,779 SF	0.41 AC
NET ACREAGE	281,182 SF	6.45 AC (100%)
EXISTING ZONING:	LIGHT INDUSTRIAL (I-L)	
PROPOSED ZONING:	LIGHT INDUSTRIAL (I-L) WITH CONDITIONAL USE PERMIT	
EXISTING GENERAL PLAN LAND USE:	LIGHT INDUSTRIAL (I-L)	
PROPOSED GENERAL PLAN LAND USE:	LIGHT INDUSTRIAL (I-L) WITH CONDITIONAL USE PERMIT	
SURROUNDING LAND USES:		
NORTH:	VACANT LAND (ZONED: LIGHT INDUSTRIAL)	
SOUTH:	VACANT LAND (ZONED: LIGHT INDUSTRIAL)	
EAST:	VACANT LAND (ZONED: LIGHT INDUSTRIAL)	
WEST:	VACANT LAND (ZONED: LIGHT INDUSTRIAL)	
PUBLIC UTILITY PURVEYORS:	ELECTRIC: SOUTHERN CALIFORNIA EDISON CO.	800-684-8123
	GAS: THE GAS COMPANY / SEMPRA ENERGY	909-335-7625
	TELEPHONE: VERIZON COMPANY	800-483-5000
	WATER: MISSION SPRINGS WATER DISTRICT	760-329-6448
	CABLE: TIME WARNER CABLE	760-340-1312
	SEWER: COACHELLA VALLEY WATER DISTRICT	760-329-6448
	USA: UNDERGROUND SERVICE ALERT	800-227-2600
EXISTING EASEMENT NOTES:		
1	60' WIDE EASEMENT IN FAVOR OF CALIFORNIA ELECTRIC POWER COMPANY PER DOCUMENT RECORDED IN BOOK 2275 PAGE 585, REC. 5/23/1953, O.R.	
FEMA FLOOD ZONE DESIGNATION:		
ZONE X - AREAS OF 0.2% ANNUAL CHANCE FLOOD; AREAS OF 1% ANNUAL CHANCE FLOOD WITH AVERAGE DEPTHS OF LESS THAN 1 FOOT OR WITH DRAINAGE AREAS LESS THAN 1 SQUARE MILE; AND AREAS PROTECTED BY LEVEES FROM 1% ANNUAL CHANCE FLOOD. FIRM NUMBER: 06065C0895G; EFFECTIVE DATE: AUGUST 28, 2008		

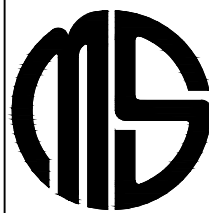

MSA CONSULTING, INC.
PLANNING ■ CIVIL ENGINEERING ■ LAND SURVEYING
34200 BOB HOPE DRIVE ■ RANCHO MIRAGE ■ CA 92270
TELEPHONE (760) 320-9811 ■ FAX (760) 323-7893